



楔形链输送案例

Contents	
Guide rails (护栏导轨)	2
Fixed guide rail brackets, aluminium (铝固定式护栏支架)	4
Accessories (附件)	6
Adjustable guide rail brackets, aluminium (铝可调护栏支架)	7
Adjustable guide rail brackets, polyamide (尼龙可调护栏支架)	9
Spacer beam for guide rail bracket support (护栏支架间隔型材)	16
Guide rail clamp for double track conveyors (双头护栏夹)	17
Accessories for guide rail bracket support (护栏支架附件)	18
Built-up guide rail brackets (组合式护栏支架)	19
Conveyor supports (输送梁支撑)	21
Conveyor beam support brackets-aluminium (铝输送梁支撑)	22
Flexible roller module (柔性滚珠模块)	26
Screws (螺丝)	27

Guide rails (护栏导轨)

FlexMod®

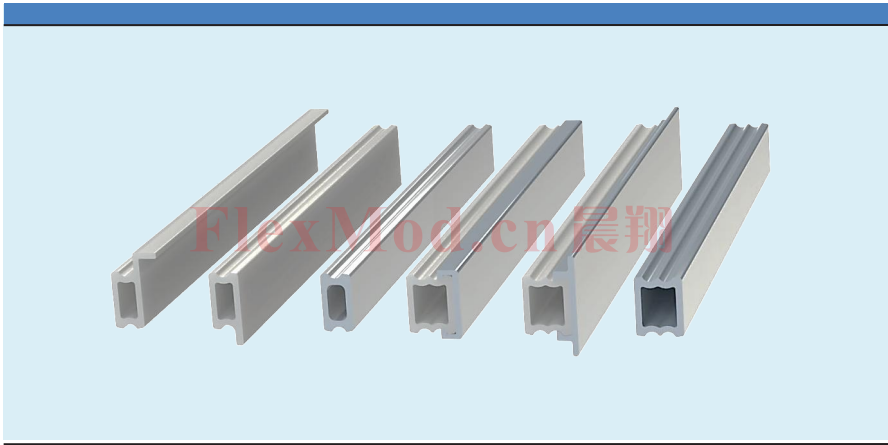

Guide rails (护栏导轨)

FlexMod®

Straight 10 mm
CXLRJ 3X10 Aluminium, length 3mt

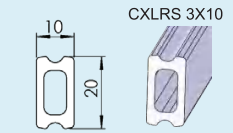

CXLRS 3X10 C Aluminium, length 3mt
*晨翔独有
(可内装M6螺母)

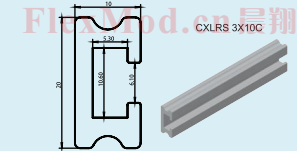

CXLRJ 10 Connecting plug 10 mm
(连接件)
CXLRJ 10 End plug 10 mm(端盖)

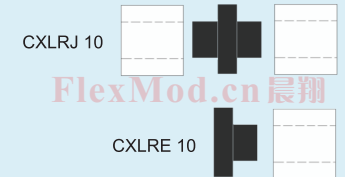

Note: Not for steel guide rail must be ordered in multiples of 25(25, 50, 75, ...)

CXLRS 3X15 Aluminium,length 3mt
(铝型材, 长度3m)

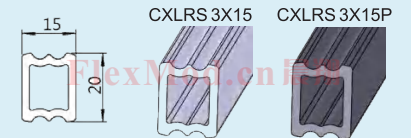

CXLRS 3X15P Polyethylene,length 3mt
(聚乙烯, 长度3m)

Guide rail cover for 15 mm guide rail
(护栏型材卡皮)

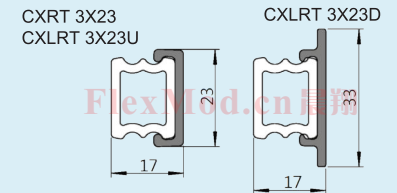

CXLRT 3X23 Polyethylene, length 3mt
(聚乙烯, 长度3m)

CXLRT 3X23 U UHMW-PE, length 3mt
(超高分子量聚乙烯, 长度3m)

CXLRT 3X33 D Polyethylene, length 3mt
(聚乙烯, 长度3m)

CXLRJ 15 Connecting plug 15 mm
(连接件)

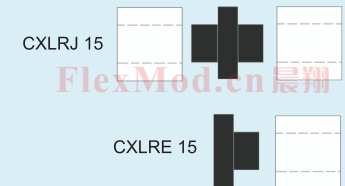

CXLRJ 15 End plug 15 mm (端盖)

CXLRJ 100 Connecting sleeve
Length 100 mm
Including set screws
(护栏连接条,长度100mm,含螺丝)

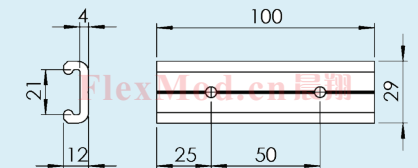

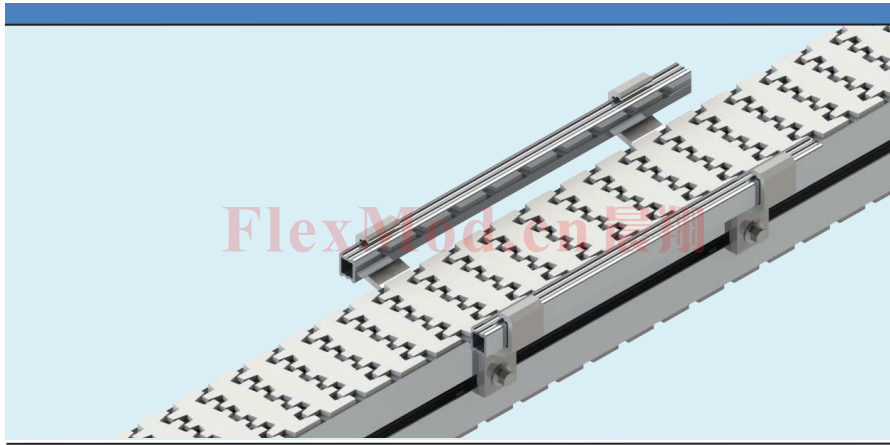

FlexMod.cn 晨雅

Brack type	CXS	CXL	CXM	CXH	CXK	CXB
CXLRB 11X30*	47	67	-	-	-	-
CXLRB 23X30	61	81	-	-	-	-
CXLRB 35X30**	85	105	-	-	-	-
CXLRB 48X30	111	131	-	-	-	-
CXLRB 29X36	82	102	-	-	-	-
CXLRB 16X42	47	67	87	107	-	184
CXLRB 28X42	71	91	111	131	-	208
CXLRB 40X42	95	115	135	155	-	232
CXLRB 49X42	113	133	153	173	-	250
CXLRB 53X42	121	141	161	181	-	258
CXLRB 65X42	145	165	185	205	-	282
CXLRB 90X42	195	215	235	255	-	332
CXLRB 16X54	-	-	-	-	107	184
CXLRB 40X54	-	-	-	-	155	232

* 10 mm guide rail only(只用于10mm宽的护栏型材)

** If type CXLRB 35X30 is used with angle plate, use 10 mm guide rail.

Guide rail bracket height 30 mm
(护栏支架高度30mm)

- CXLRB 11X30 W= 11 mm Fig. A
 - CXLRB 23X30 W= 23 mm Fig. A
 - CXLRB 35X30 W= 35 mm Fig. B
 - CXLRB 48X30 W= 48 mm Fig. B
 - CXLRB 29X36 Height 36 mm
W= 29 mm
- Guide rail bracket
for CXL pallets.
(CXL托盘输送用护栏支架)

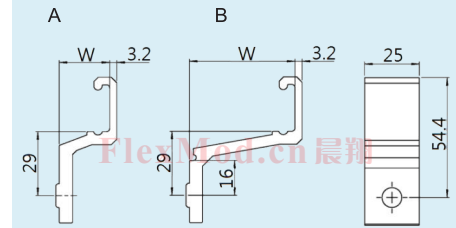

Guide rail bracket height 42 mm
(护栏支架高度42mm)

- CXLRB 16X42 W= 16 mm Fig. A
- CXLRB 28X42 W= 28 mm Fig. A
- CXLRB 40X42 W= 40 mm Fig. B
- CXLRB 49X42 W= 49 mm Fig. B
- CXLRB 53X42 W= 53 mm Fig. B
- CXLRB 65X42 W= 65 mm Fig. B
- CXLRB 90X42 W= 90 mm Fig. B

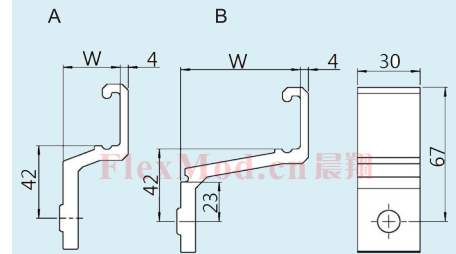

Guide rail bracket height 54 mm
(护栏支架高度54mm)

- CXLRB 16X54 W= 16 mm Fig. A
- CXLRB 40X54 W= 40 mm Fig. B

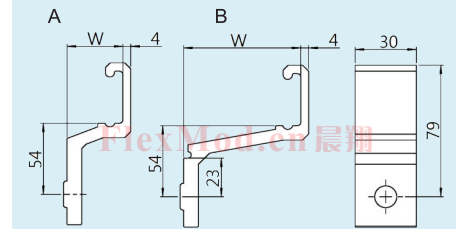

CXLRD 6 Distance piece(aluminium)
(铝垫片)
Thickness 6.25 mm
(厚度6.25mm)

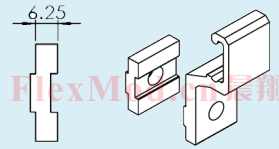

CXLRD 6 C Distance piece(aluminium)
(铝垫片)
for conveyor system CXK
(用于CXK输送系统)
Thickness 6.25 mm
(厚度6.25mm)

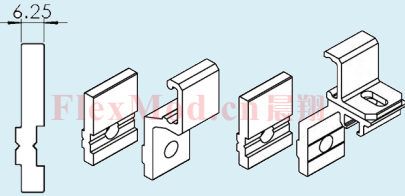

CXLRD 6 P Distance piece(polyamide)
(尼龙垫片)
Thickness 6.25 mm
(厚度6.25mm)
CXLRD 6 P can hold angle
plates (CXL only) not for
CXK

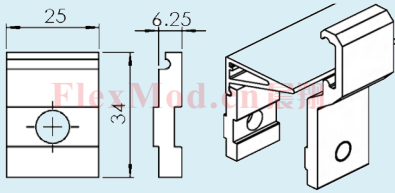

CXLAP 28 Spring pin for guide rail
bracket
(护栏支架用弹簧销)

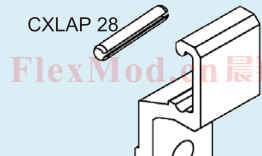

Brack type	CXS	CXL	CXM	CXH	CXK	CXB
CXLRA 8X9X45	16-34	36-54	-	-	-	-
CXLRA 8X39X45	0-34	0-54	-	-	-	-
CXLRA 26X9X45	52-70	72-90	-	-	-	-
CXLRA 26X39X45	0-70	12-90	-	-	-	-
CXLRA 16X30X52	0-49	9-69	29-89	49-109	-	126-186
CXLRA 41X30X52	39-99	59-119	79-139	99-159	-	176-236
CXLRA 16X30X64	-	-	-	-	49-109	126-186

Adjustable guide rail
bracket assembly
Including bolt and nut
(可调护栏支架含螺丝螺母)

CXLRA 8X9X45 See Figure A, C
CXLRA 8X39X45 See Figure B, C

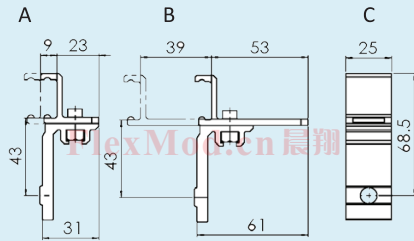

CXLRA 26X9X45 See Figure D, F
CXLRA 26X39X45 See Figure E, F

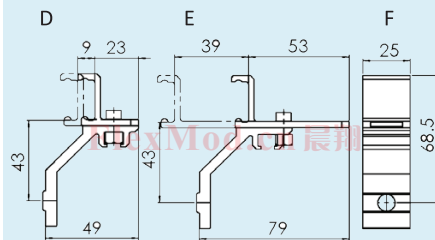

Adjustable guide rail
bracket assembly
Including bolt and nut
(可调护栏支架含螺丝螺母)

CXLRA 16X30X52 See Figure A, C
CXLRA 41X30X52 See Figure B, C

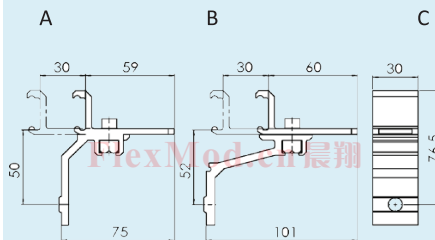

Adjustable guide rail
bracket assembly
Including bolt and nut
(可调护栏支架含螺丝螺母)

CXLRA 16X30X64

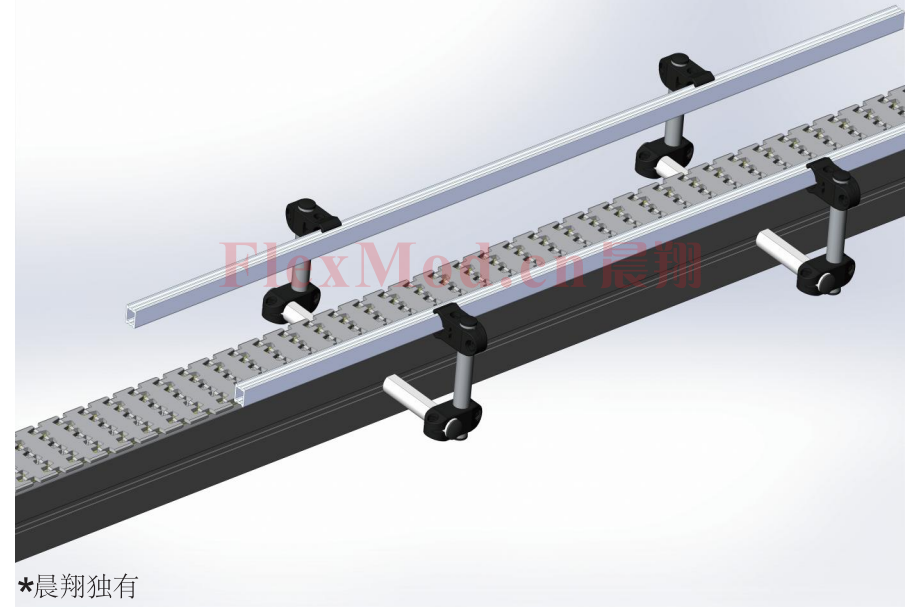
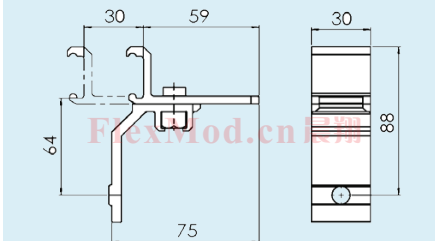

*晨翔独有

CXGRS 18 Guide Rail Support -Polyamide (护栏夹, 尼龙)

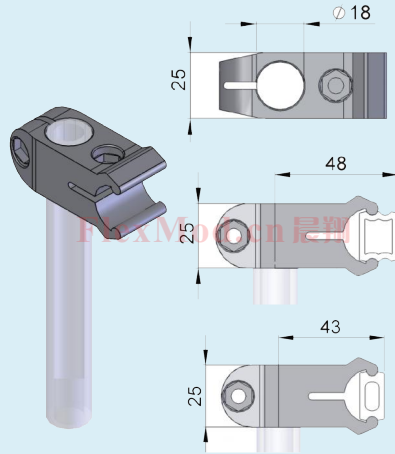

Cross connector(十字连接件)

CXGRB 18x18 Guide Rail Bracket, ØA = 18mm, ØB = 18mm -Polyamide (十字夹 18x18mm, 尼龙)

CXGRB 18x20 Guide Rail Bracket, ØA = 18mm, ØB = 20mm -Polyamide (十字夹 18x20mm, 尼龙)

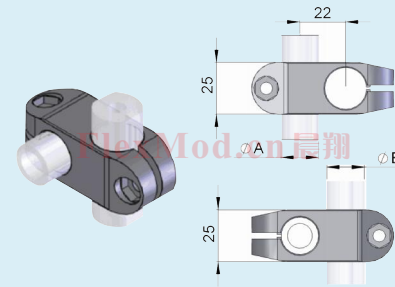

CXGRT 20x70 Distance Tube, L = 70mm Aluminium(支架横管长度70mm, 铝)

CXGRT 20x80 Distance Tube, L = 80mm Aluminium(支架横管长度80mm, 铝)

CXGRT 20x100 Distance Tube, L = 100mm Aluminium(支架横管长度100mm, 铝)

CXGRT 20x150 Distance Tube, L = 150mm Aluminium(支架横管长度150mm, 铝)

CXGRT 20x200 Distance Tube, L = 200mm Aluminium(支架横管长度200mm, 铝)

CXGRT 20x250 Distance Tube, L = 250mm Aluminium

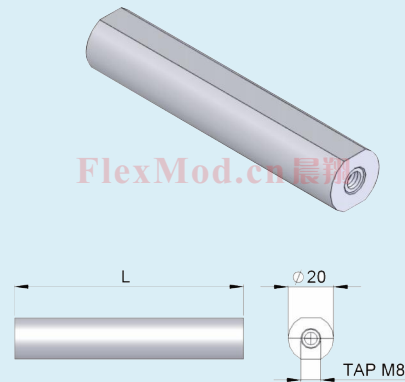

CXGRT 18x100 18mm Tube, L = 100mm Aluminium (支架竖管长度100mm, 铝)

CXGRT 18x150 18mm Tube, L = 150mm Aluminium (支架竖管长度150mm, 铝)

CXGRT 18x200 18mm Tube, L = 200mm Aluminium (支架竖管长度200mm, 铝)

CXGRT 18x250 18mm Tube, L = 250mm Aluminium (支架竖管长度250mm, 铝)

CXGRT 18x300 18mm Tube, L = 300mm Aluminium (支架竖管长度300mm, 铝)

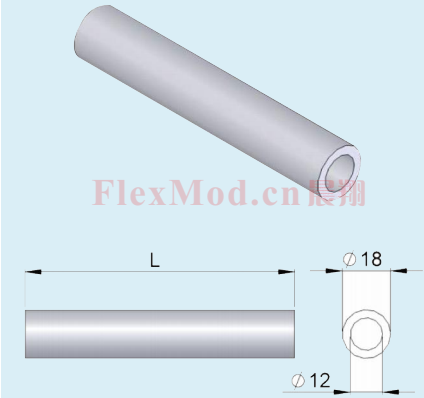

CXGEC 18 18mm Tube End Cap Polyamide (18mm 铝管端盖, 尼龙)

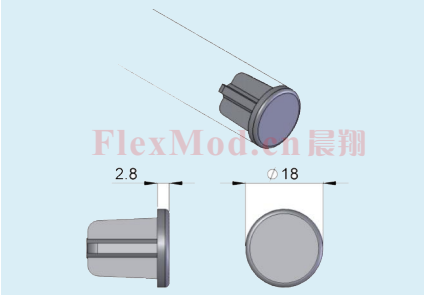

CXGEC 20 Distance Tube End Cap Polyamide (20mm 铝管端盖, 尼龙)

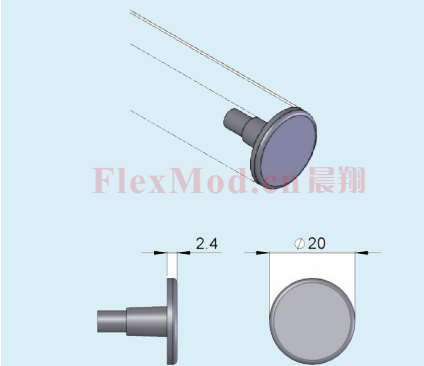

Guide Rail Assembly

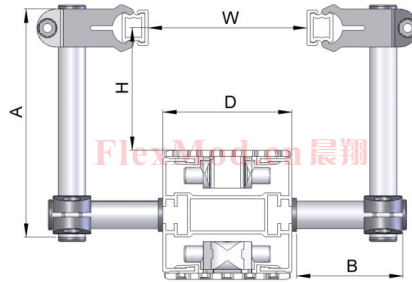

A (mm)	Series	D (mm)	H (mm) Min	H (mm) Max
CXGRT 18x100	CXS	45	17	35
CXGRT 18x100	CXL	65	17	35
CXGRT 18x100	CXM	85	17	30
CXGRT 18x100	CXH	105	17	30

B (mm)	Series	D (mm)	W (mm) Min	W (mm) Max
CXGRT 20x70	CXS	45	0	65
CXGRT 20x70	CXL	65	0	85
CXGRT 20x70	CXM	85	16	105
CXGRT 20x70	CXH	105	36	125

A (mm)	Series	D (mm)	H (mm) Min	H (mm) Max
CXGRT 18x150	CXS	45	17	85
CXGRT 18x150	CXL	65	17	85
CXGRT 18x150	CXM	85	17	80
CXGRT 18x150	CXH	105	17	80

B (mm)	Series	D (mm)	W (mm) Min	W (mm) Max
CXGRT 20x100	CXS	45	0	125
CXGRT 20x100	CXL	65	0	145
CXGRT 20x100	CXM	85	16	165
CXGRT 20x100	CXH	105	36	185

A (mm)	Series	D (mm)	H (mm) Min	H (mm) Max
CXGRT 18x200	CXS	45	17	135
CXGRT 18x200	CXL	65	17	135
CXGRT 18x200	CXM	85	17	130
CXGRT 18x200	CXH	105	17	130

B (mm)	Series	D (mm)	W (mm) Min	W (mm) Max
CXGRT 20x150	CXS	45	0	225
CXGRT 20x150	CXL	65	0	245
CXGRT 20x150	CXM	85	16	265
CXGRT 20x150	CXH	105	36	285

A (mm)	Series	D (mm)	H (mm) Min	H (mm) Max
CXGRT 18x250	CXS	45	17	185
CXGRT 18x250	CXL	65	17	185
CXGRT 18x250	CXM	85	17	180
CXGRT 18x250	CXH	105	17	180

B (mm)	Series	D (mm)	W (mm) Min	W (mm) Max
CXGRT 20x200	CXS	45	0	325
CXGRT 20x200	CXL	65	0	345
CXGRT 20x200	CXM	85	16	365
CXGRT 20x200	CXH	105	36	385

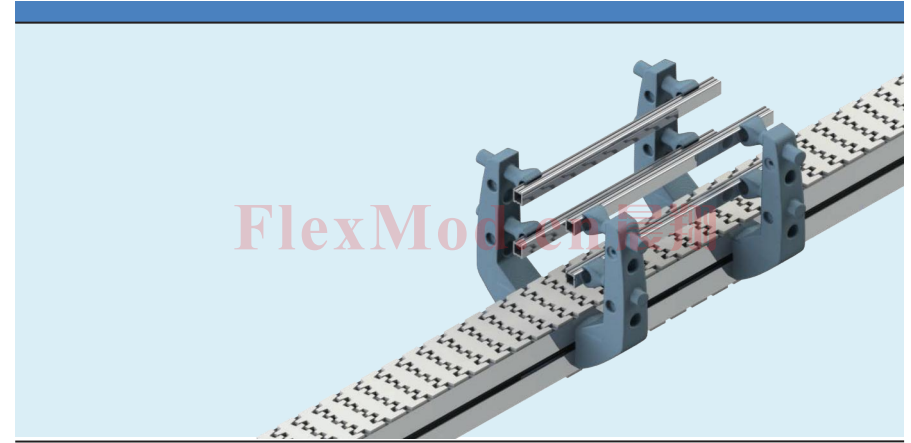

CXLRF 42X62 A35
For 1-2 guide rail levels(2级可调)

CXLRF 42X62 A110
For 1-4 guide rail levels(4级可调)

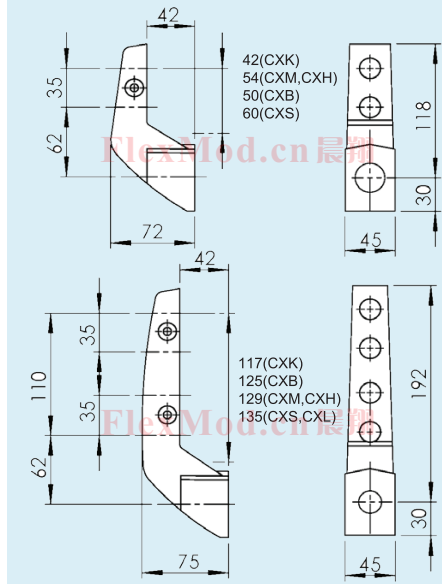

Fixed guide rail bracket, polyamide
(尼龙固定式护栏支架)

(CXS, CX65)
CXLRB 11X30 C

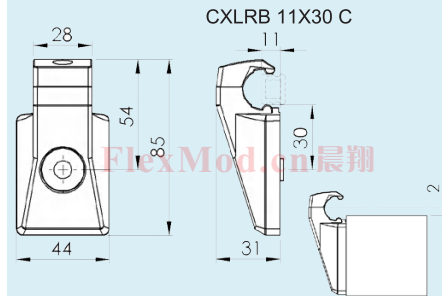

Fixed guide rail bracket, polyamide
(固定式护栏支架, 尼龙)

(CXS, CX65, CX85, CXH, CX175/CX295)
CXLRB 40X42 C
CXLRB 16X42 C

Can be used with CXS, CX65, CX85, CXH, CX175/CX295 conveyor beam.

Mounting to beam:

CXLAT 17, CXLAN 8, BRB 8.4X16

Do not overtighten (max torque: 10Nm)

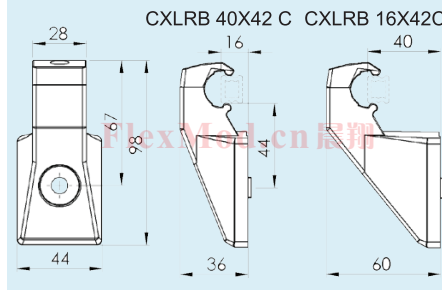

CXLAK 18 Dummy plug(端盘)

CXLAK 18

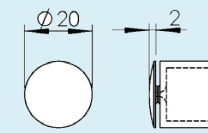

CXLRF 42X18 V Guide rail bracket support
With clamp for 18 mm tube
(护栏支架适用于18mm的管件)

CXLRF 42X18V

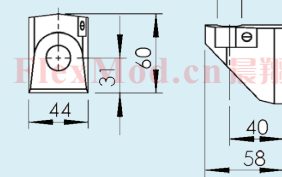

CXLRF 40X18 Guide rail bracket support
With clamp for 18 mm tube
(护栏支架适用于18mm的管件)

CXLRF 40X18

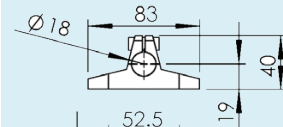

CXLRD 30 Distance piece for CXLRF 40X18
(垫片)

CXLRD 30

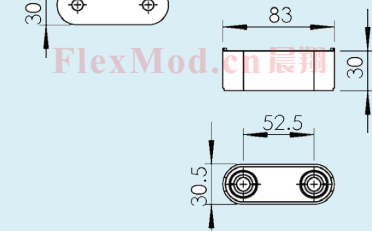

CXLRF 40X18 VH Reinforced Guide rail bracket support,(加强护栏支架)
material: Zinc
(材料: 锌合金)

To be used with vertical 18 mm tube or rod, guide rail clamp(适用于18mm的竖管)
CXLR/L/CXLR C 18×110C, or with quick release clamp CXLR/L 18×97CQ.

Mounting to beam: CXLAT 17, CXLAN 8, BRB 8.4×16

Use socket wrench with 3/8" drive.
Do not overtighten (max torque: 10 Nm).

CXLRF 42X18VH

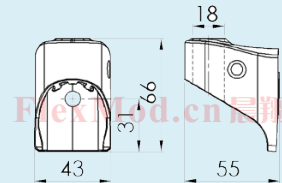

CA

Spacer beam for guide rail bracket support (护栏支架间隔型材) FlexMod®

Spacer beam(间隔型材)

CXLRN 3U Beam with flat sides, length 3m(长度3m)

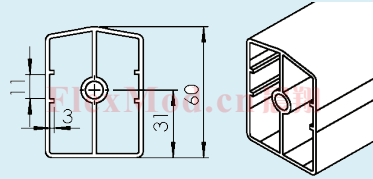

CXLRN 3 Beam with T-slots, length 3m(型材带T-槽, 长度3m)

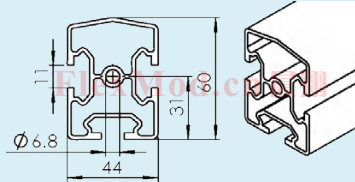

CXLRD 3 D Spacer beam connector (间隔型材连接条)
Width 3 mm
For use with spacer beam type CXLRN 3U

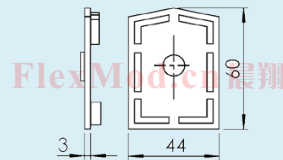

Distance piece Type A(垫片)

CXLRD 6 A D= 6 mm
CXLRD 18 A D= 18 mm

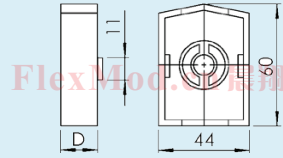

Guide rail clamp 1(护栏夹1)

CXLRK 18X40 C L= 40 mm
CXLRK 18X60 C L= 60 mm
CXLRK 18X80 C L= 80 mm

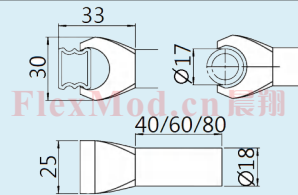

Guide rail clamp 2(护栏夹2)
CXLRL 18X110 C

Including screw(含螺丝)
To be used directly with CXLRF 42X18V

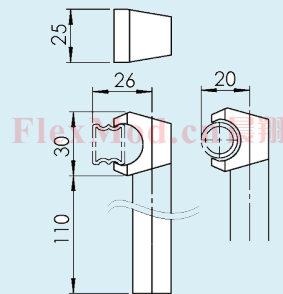

CA-16

Guide rail clamp for double track conveyors (双头护栏夹) FlexMod®

Guide rail clamp 3(护栏夹3)
CXLRK 18 CE

Including screw and nut (含螺丝螺母)

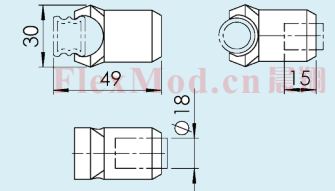

Guide rail clamp 4(护栏夹4)
CXLRK 12 CE

Including screw and nut (含螺丝螺母)

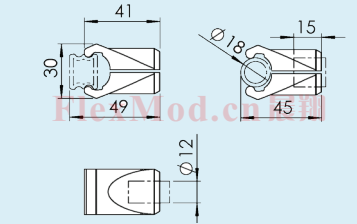

CXLRC 18X110 C

Guide rail clamp for double track conveyors
Including screw and nut (双头护栏夹含螺丝螺母)

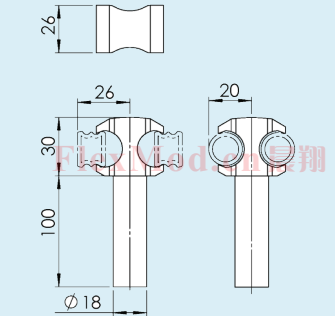

Guide rail clamp supports
Including screw and nut (双头护栏夹含螺丝螺母)

For use with CXLRK 18x40/60/80 C

CXLRL 18X60 CA L= 60 mm
CXLRL 18X110 CA L= 110 mm
CXLRL 18X160 CA L= 160 mm

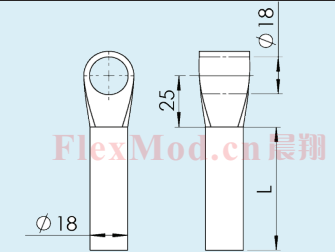

CXLRK 12DE

Including screw and nut (含螺丝螺母)

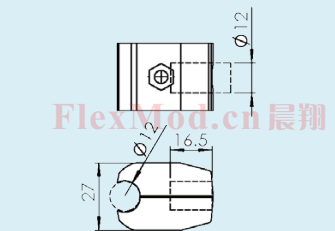

www.flexmod.cn

CA-17

CA

Guide rail support tube(护栏支架铝管)
CXLRR 3X18 C Length 3mt(长度3m)

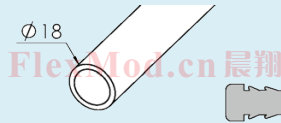

CXLRZ 18 End cap(端盖)

CXLRX 18 C
Corner connector(拐角连接件)
Including screws and nuts
(含螺丝螺母)

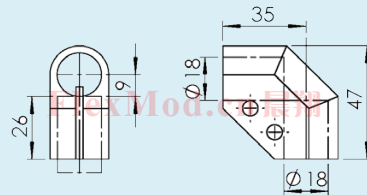

CXLRX 18 X
Cross connector(十字连接件)
Including screws nut.(含螺丝螺母)
Can be used with star knob CXLAR 6X20
(see below) for easy readjustment

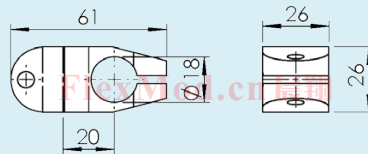

CXLAR 6X20
Star Knob(星形把手)
M6

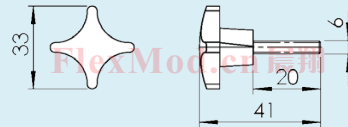

CX5051168
Guide rail clamp rod with groover
Stainless steel .For use with guide rail
clamps CXLRK 12 CE/DE and clamp
support CXLRL 18x97 CQ

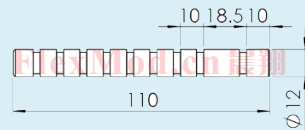

CX5050986
Guide rail clamp rod.
Stainless steel .For use with guide rail
clamps CXLRK 12 CE/DE and clamp
support CXLRF 30X71 K



CXLRL 18X97 CQ
Quick release guide rail clamp support
For use with guide rail bracket support
CXLRF 42X18 V

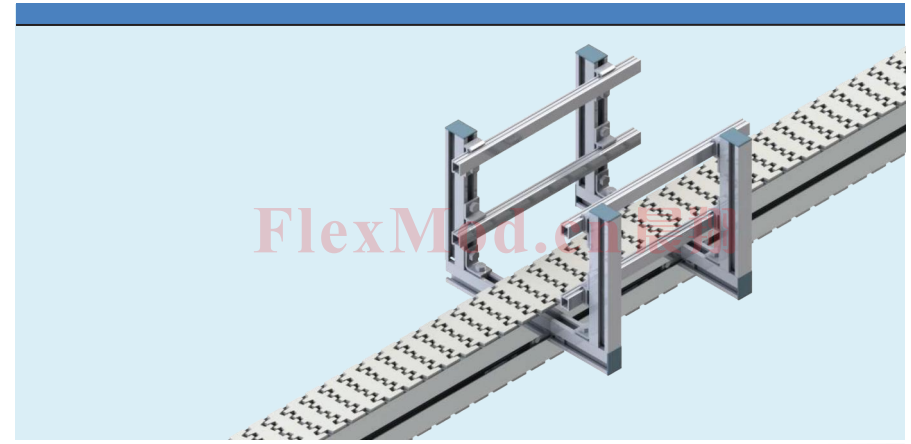
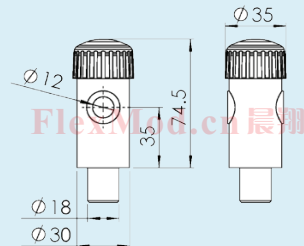

CXLRC 20 Guide rail bracket
(护栏支架)

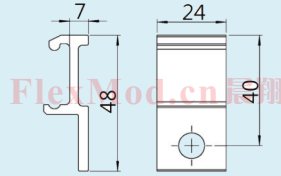

CXLRC 20 A Guide rail bracket(护栏支架)
Including M8 screw and square nut
(包括螺丝和方形螺母)

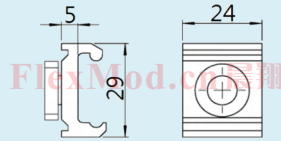

CXMRX 20 Inner fitting 90°
Including T-bolt, nut, set screw
(90°内置件含螺丝)

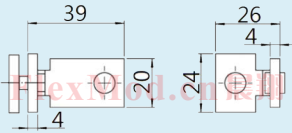

CXMRY 20 Inner fitting 90°
Including screws
(90°内置件含螺丝)

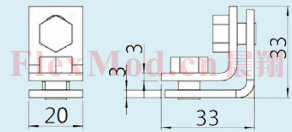

CXMRW 20 Corner fitting 90°
Including set screws
(90°拐角固定件)

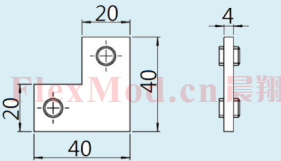

CXLAP 28 Spring pin for guide rail bracket
(护栏支架用弹簧销)

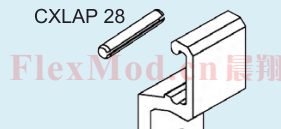

Conveyor beam support brackets-aluminium (铝输送梁支撑) FlexMod®

Beam support bracket(梁体支架)
For 80 mm crossing support beam
(国标80mm横梁型材专用)

CXLCT 21X113 h= 113 mm
*晨翔独有

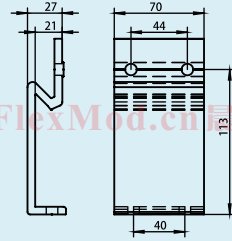

Beam support bracket(梁体支架)
For 88 mm crossing support beam
(88mm横梁型材用)

CXLCT 21X100 h= 100 mm
CXLCT 21X125 h= 125 mm
CXLCT 21X135 h= 135 mm

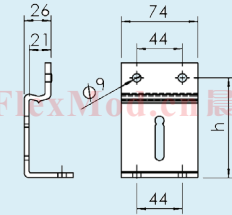

Beam support bracket(梁体支架)
For 88 mm crossing support beam
(88mm横梁型材用)

CXLCT 21X158 R*

*Use T-slot screw CXLAT 24 with this beam support bracket. (CXLAT 17 is too short.)

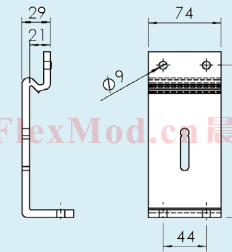

Beam support bracket(梁体支架)
For 64 mm crossing support beam
(64mm横梁型材用)

CXLCT 21X100 A h= 100 mm
CXLCT 21X135 A h= 135 mm

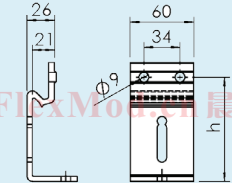

CXLCT 21X135 B h= 135 mm

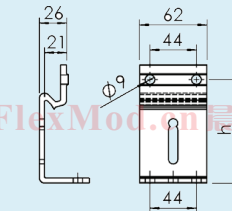

Conveyor beam support brackets-aluminium (铝输送梁支撑) FlexMod®

Beam support bracket(梁体支架)
For 44 mm vertical support beam
(44mm型材专用)

CXUCS 44A
For CX45 conveyor D= 6.8 mm

CXS 44
For CXS conveyor D= 9 mm

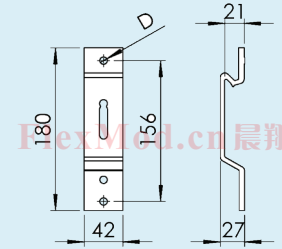

Beam support bracket(梁体支架)
For 64 mm vertical support beam
(64mm型材专用)

CXLCS 44
For CXL conveyor D= 9 mm

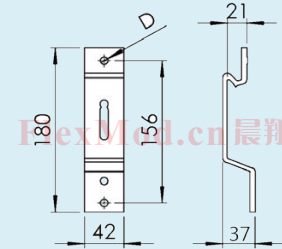

Beam support bracket(梁体支架)
For 64 mm vertical support beam
(64mm型材专用)

CXSCS 64
For CXS conveyor

CXLCS 64
For CXL conveyor

CXMCS 64
For CXM conveyor

CXMCS 64 B
For CXM conveyor

CXHCS 64
For CXH conveyor

CXHCS 64 B
For CXH conveyor

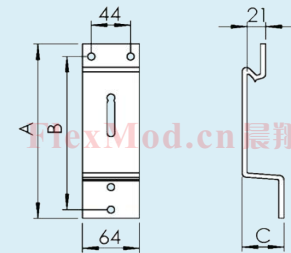

	A	B	C
CXSCS 64	180	156	17
CXLCS 64	180	156	27
CXMCS 64	180	156	37
CXMCS 64B	200	176	37
CXHCS 64	180	156	47
CXHCS 64B	200	176	47

Conveyor beam support brackets-aluminium (铝输送梁支撑) FlexMod®

Beam support bracket(梁体支架)
For 88 mm vertical support beam
(88mm型材专用)

CXLCS 88
For CXL conveyor
CXMCS 88 B
For CXM conveyor
CXKCS 88 R*
For CXK conveyor

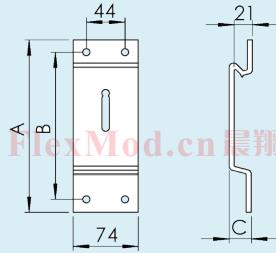

CXHCS 88
For CXH conveyor
CXHCS 88 B
For CXH conveyor

*Use T-slot screw CXLAT 24 with this
Beam support bracker. (CXLAT 17 is too
short.)

	A	B	C
CXLCS 88	180	151	15
CXMCS 88B	200	171	25
CXKCS 88R	220	176	38
CXHCS 88	180	151	35
CXHCS 88B	200	171	35

Beam support bracket(梁体支架)
For 80 mm vertical support beam
(国标80mm型材专用)

CXMCS 80
For CXM conveyor
(CXM输送梁专用)
*晨翔独有

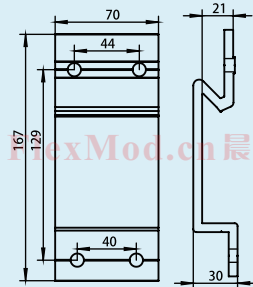

Beam support bracket(梁体支架)
For 80 mm vertical support beam
(国标80mm型材专用)

CXHCS 80
For CXH conveyor(CXH输送梁专用)
*晨翔独有

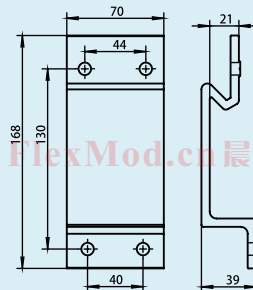

Conveyor beam support brackets-aluminium (铝输送梁支撑) FlexMod®

Beam support bracket(梁体支架)
For support of 180° wheel
bend with 88 mm vertical
support beam(88mm型材专用)

CXLCU 73 For conveyor systems
CXL, CXM, CXH, D=73.5 mm
CXLCU 103 For conveyor systems
CXK, D=103.5 mm

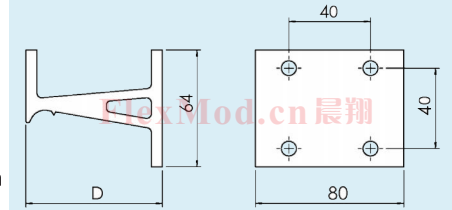

Beam support bracket(梁体支架)
For support of 180° wheel
bend with 80 mm vertical
support beam(国标80mm型材专用)

CXLCU 73GB For conveyor systems
CXL, CXM, CXH, D=73.5 mm
CXLCU 103GB For conveyor systems
CXK, D=103.5 mm

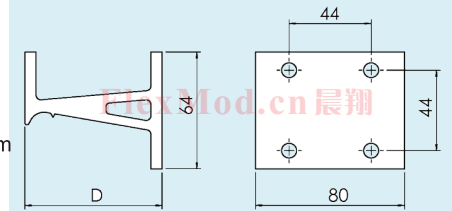

Flexible roller module (柔性滚珠模块)

FlexMod®

Flexible roller module(柔性滚珠模块)

CX5050902

Flexible roller module(柔性滚珠模块)

Length 348 mm

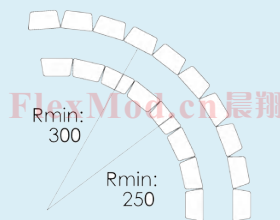
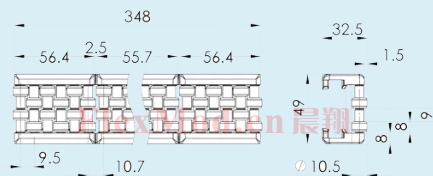

Mounting to profile CX5050889:

SK6SS 4x20

Rod for roller module profile

(滚珠模块固定棒)

CX5050887

Rod for roller module profile $\phi 12$

(滚珠模块固定棒)

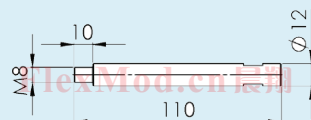

Mounting to roller module profile

CX5050889: CXCAN 8, BRB 8.4x16

For use with guide rail bracket support Type K.

Roller module profile

(滚珠模块型材)

Roller module profile(滚珠模块型材)

Length 3 mt(长度3m)

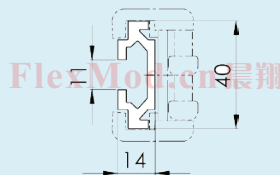

For use with roller module CX5050902.

Use connecting strip CXLCJ 5X140 for joints.

CA-26

Screws (螺丝)

FlexMod®

T-bolts(T型螺丝)

CXLAT 17 L= 17 mm

CXLAT 24 L= 24 mm

CXLAT 35 L= 35 mm

CXLAT 53 L= 53 mm

CXLAT 71 L= 71 mm

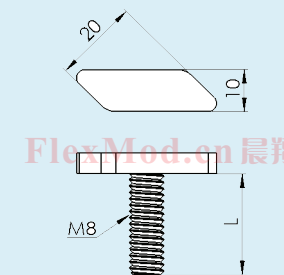

Nut(防滑螺母)

CXLAN 8

Locking nut M8 for T-bolt, include washer BRB 8,4X16

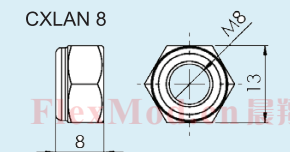

BRB 8.4X16

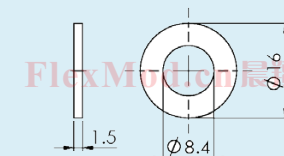

Locking lever, nut type(锁定手柄)

CXLAL 8

Locking lever with M8 thread

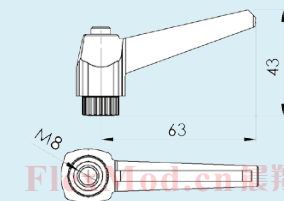

CXLAL 8X10

Locking lever with M8 screw, thread length 10 mm

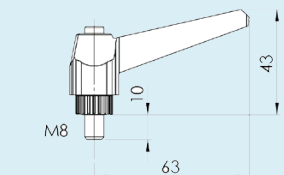

www.flexmod.cn

CA-27

CA