

Contents (目录)	2	Examples of application (应用场合)	18
Chains (链条)	2		
Conveyor beam (输送梁)	4		
End drive units (驱动单元)	7		
Idler end units (从动单元)	10		
Horizontal wheel bends (水平轮弯头)	11		
Horizontal plain bends (水平平弯头)	13		
Vertical bends (垂直弯头)	15		

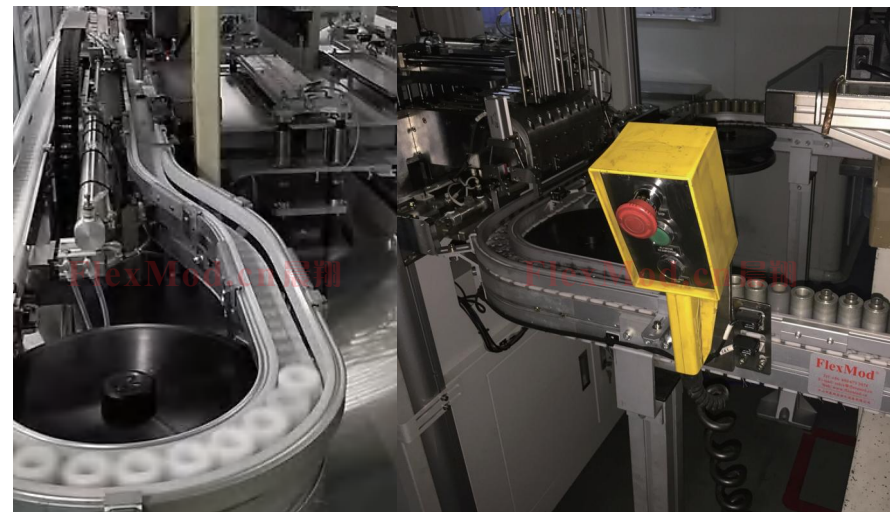

CXS

Chain width 44 mm (链宽44mm)



Technical characteristics (技术指标)

Chain tension limit (链条张力极限)500 N
Beam width (型材宽度)45 mm
Chain width (链条宽度)44 mm
Chain pitch (链条节距)25.4 mm
Item width (输送物品宽度)10-80 mm
Maximum item weight (输送物品重量)	
Horizontal transport (水平传送)2 kg
Vertical transport (垂直传送)1 kg
Maximum weight on conveyor (线体最大承载)150 kg
Maximum conveyor length (线体最大长度)30 m

Examples of application

Small ball bearings, perfume bottles, pharmaceutical bottles, sintered metal components.

应用场合

小型球轴承、香水瓶、药瓶、喷雾罐、电池、金属烧结制品等。

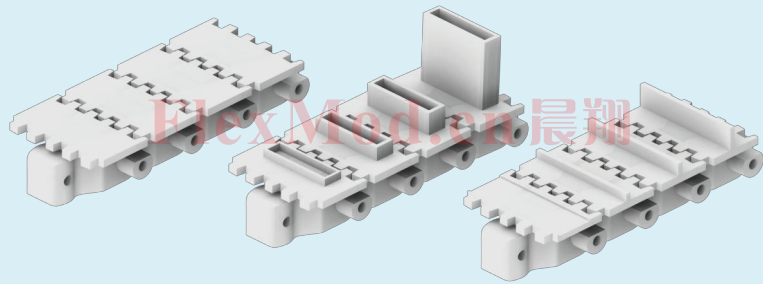

Plastic chain materials(链板材质)	Performance(特性)	Colour(颜色)
POM	Standard material/标准材料	white/白色
POML	Ultra low wear/超润滑	white/白色
POMA	Abrasion resistance/超耐磨	white/白色
POMC	Chemical resistance/抗腐蚀	yellow/黄色
POME	Conductive material/抗静电	black/黑色
POMK	High temperature resistance/耐高温	yellow/黄色
POMF	Food application/用于食品	white/白色
POMN	Low noise/低噪音	white/白色

Plain chain (平板链)

CXSTP 5 Plain chain (平板链)
Length 5 mt (长度5m)

CXSTL 44 Plain link (平板链节)

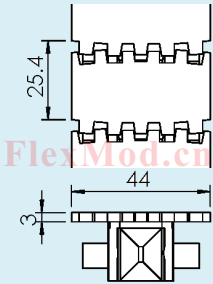
*Cleated chain* (楔链)
Type D cleats
Length 3 mt (长度3m)

CXSTF 5X3 D... H=3 mm
 CXSTF 5X5.5 D... H=5.5 mm
 CXSTF 5X9 D... H=9 mm
 CXSTF 5X20 D... H=20 mm
 CXSTF 5X27 D... H=27 mm

Cleated link (楔链节)

CXSTL 44X3 D H=3 mm
 CXSTL 44X5.5 D H=5.5 mm
 CXSTL 44X9 D H=9 mm
 CXSTL 44X20 D H=20 mm
 CXSTL 44X27 D H=27 mm

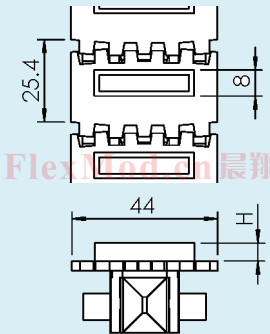
*Cleated chain* (楔链)
Type G cleats
Length 3 mt (长度3m)

CXSTF 5X3 G... H=3 mm
 CXSTF 5X5 G... H=5 mm
 CXSTF 5X9 G... H=9 mm

Cleated link (楔链节)

CXSTL 44X3 G H=3 mm
 CXSTL 44X5 G H=5 mm
 CXSTL 44X9 G H=9 mm

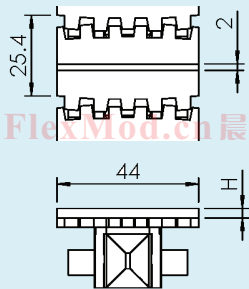
*Tools and accessories* (工具和附件)

CXLTT 9X16 Plastic pivot (塑料珠)

CXLTD 4X36 Steel pin (钢销)

CXLMJ 4 Pin insertion tool (销子安装工具)

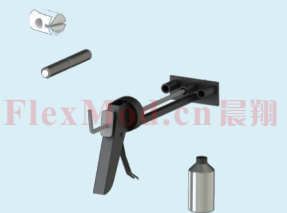

Conveyor beam (输送梁)

FlexMod®

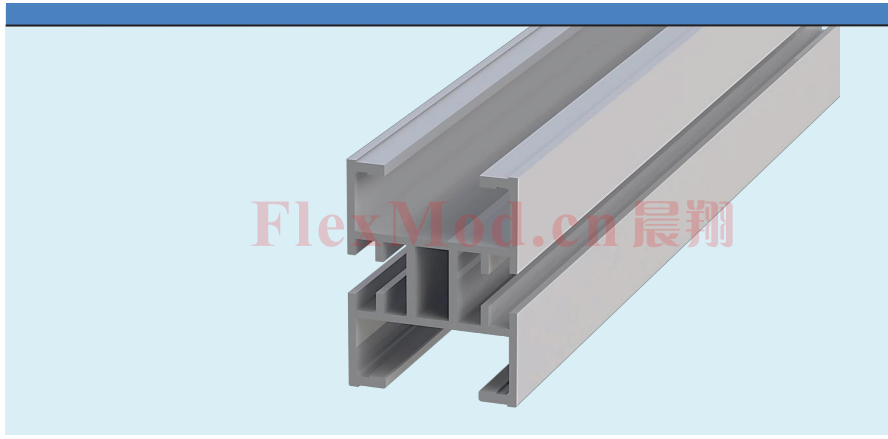

Conveyor beam (输送梁)

FlexMod®

Beam (输送梁)

CXSCB 3 Length 3 m (长度3m)

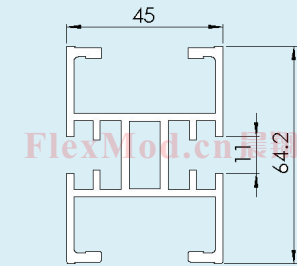

Slide rail (耐磨条) Length 25 m (长度25m)

CXSCR 25 Polyethylene (聚乙烯)
HDPE White/Black

CXSCR 25U UHMW White
(高分子量聚乙烯)

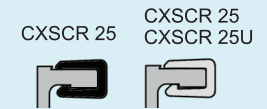

CXLAH 3X6A Aluminium rivet (铝铆钉)

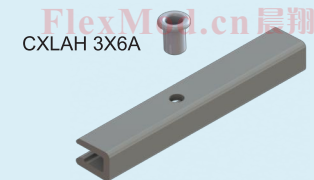

Connecting strip with set screws
(梁体连接条)

CXSCJ 6X160 Length 160 mm

CXSCJ 6X130 Length 130 mm

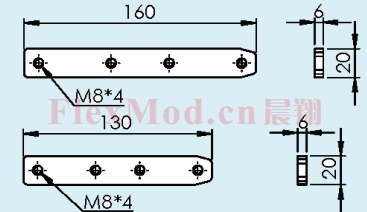

T-slot cover, 50M/Rol (防尘胶条)

CXLAB 50 Length 50 m (长度50m)

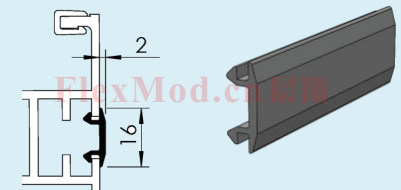

CX3924774 Drill fixture for slide rail
(耐磨条安装工具)

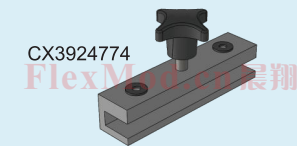

Conveyor beam (输送梁)

FlexMod®

Beam outer (外侧半梁)

CXSCB 3H Length 3 m(长度3m)

Beam inner (内侧半梁)

CXSCB 3J Length 3 m(长度3m)

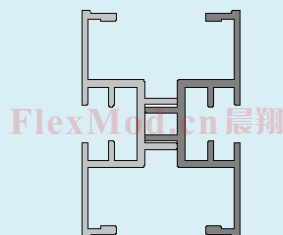
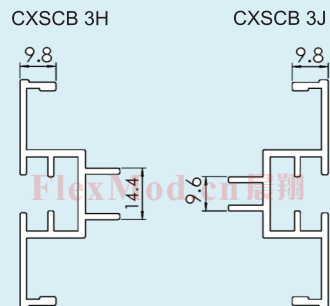

CXSCC 160 Beam section for chain Installation including connection strips and screws (链条拆装用活接梁)

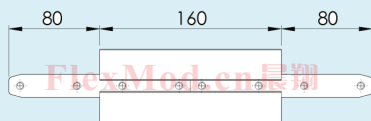

Beam spacer(型材隔条)

CXLCD 3 Aluminium, anodized Length 3mt (长度3m)

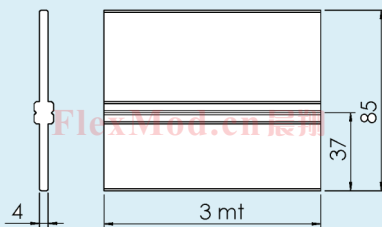

CXS	H=16.0mm
CXL	H=15.9mm
CXM/CX85/CXH	H=10.5mm
CXK	H=0.5mm

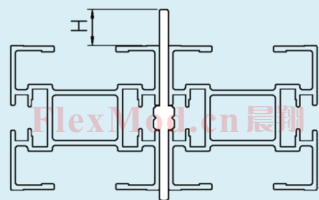

CXM-6

End drive units (驱动单元)

FlexMod®



CXSEB 0HLA Drive unit (驱动单元)
Transmission on left-hand side (传动装置在左侧)

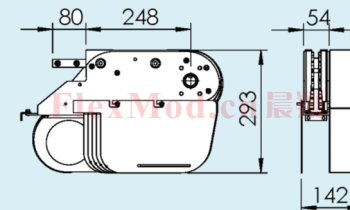

CXSEB 0HRA Drive unit (驱动单元)
Transmission on right-hand side (传动装置在右侧)

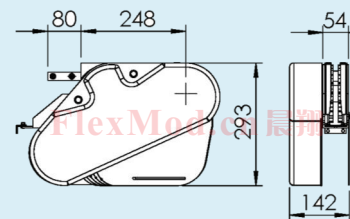

www.flexmod.cn

CXS-7

CXS

End drive units (驱动单元)

FlexMod®

CXSEB 0HLGP Drive unit (驱动单元)
Direct drive without
slack, left-hand side
(左出轴)

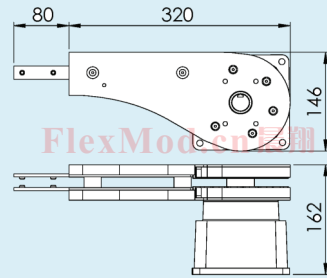

CXSEB 0HRGP Drive unit (驱动单元)
Direct drive without
slack, right-hand side
(右出轴)

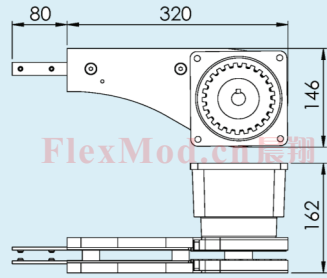

CXS-8

Horizontal bend drive unit (水平驱动单元)

FlexMod®



CXSEW 180/0H Horizontal bend
drive unit, 180°
(水平驱动单元180°)

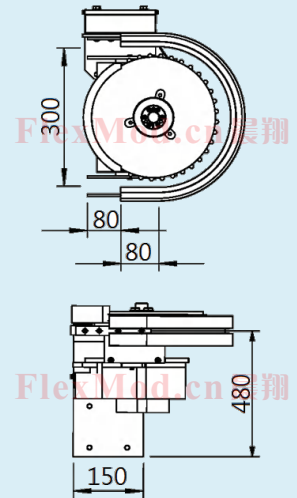

www.flexmod.cn

CXS-9

CXS

Idler end units (从动单元)

FlexMod®

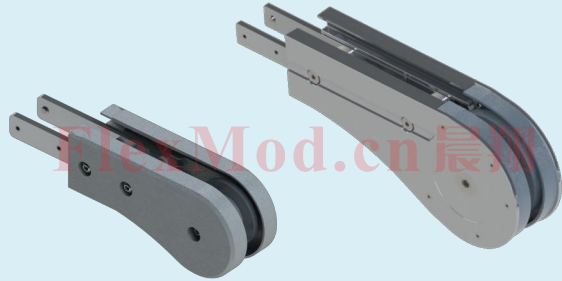

CXSEJ 320 Idler end unit(从动单元)

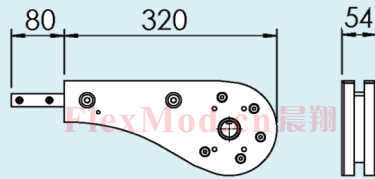

CXSEJ 200 Idler end unit(从动单元)

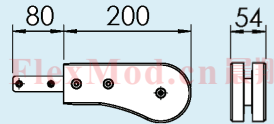

Horizontal wheel bends (水平轮弯头)

FlexMod®



CXS

Horizontal wheel bends (水平轮弯头)

FlexMod®

Horizontal wheel bend, 30° (水平轮弯头30°)

CXSBH 30R150 Radius to centre of chain 150 mm
(链条中心半径150mm)
CXSBH 30R150A with protective cover

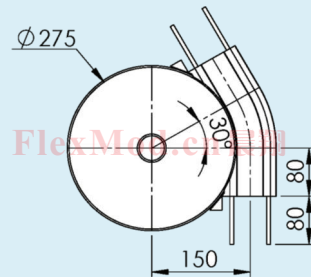

Horizontal wheel bend, 45° (水平轮弯头45°)

CXSBH 45R150 Radius to centre of chain 150 mm
(链条中心半径150mm)
CXSBH 45R150A with protective cover

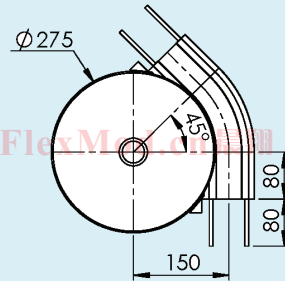

Horizontal wheel bend, 90° (水平轮弯头90°)

CXSBH 90R150 Radius to centre of chain 150 mm
(链条中心半径150mm)
CXSBH 90R150A with protective cover

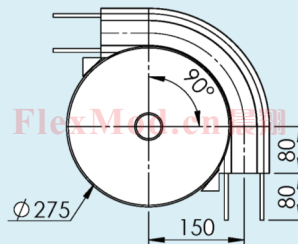

Horizontal wheel bend, 180° (水平轮弯头180°)

CXSBH 180R150 Radius to centre of chain 150 mm
(链条中心半径150mm)
CXSBH 180R150A with protective cover

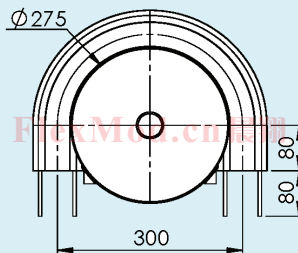

Horizontal plain bends (水平弯头)

FlexMod®



Horizontal plain bends (水平弯头)

FlexMod®

Horizontal plain bend, 30° (水平弯头30°)

Radius to centre of beam:

(输送梁中心半径)

CXSBP 30R500 R=500 mm

CXSBP 30R700 R=700 mm

CXSBP 30R1000 R=1000mm

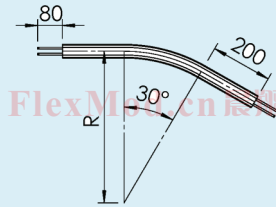

Horizontal plain bend, 45° (水平弯头45°)

Radius to centre of beam:

(输送梁中心半径)

CXSBP 45R500 R=500 mm

CXSBP 45R700 R=700 mm

CXSBP 45R1000 R=1000mm

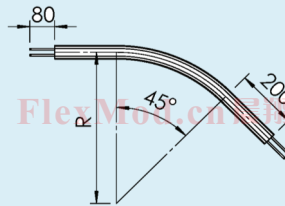

Horizontal plain bend, 60° (水平弯头60°)

Radius to centre of beam:

(输送梁中心半径)

CXSBP 60R500 R=500 mm

CXSBP 60R700 R=700 mm

CXSBP 60R1000 R=1000mm

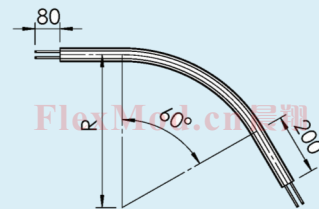

Horizontal plain bend, 90° (水平弯头90°)

Radius to centre of beam:

(输送梁中心半径)

CXSBP 90R500 R=500 mm

CXSBP 90R700 R=700 mm

CXSBP 90R1000 R=1000mm

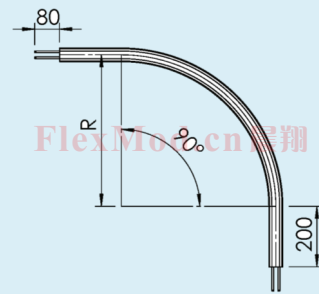

Vertical bends (垂直弯头)

FlexMod®

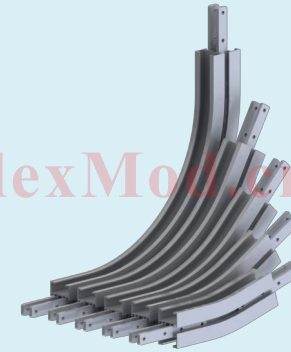

CXS

Vertical bends (垂直弯头)

FlexMod®

Vertical bend, 5° (垂直弯头5°)

Radius to centre of beam:

(输送梁中心半径)

CXSBV 5R300 R=300 mm

CXSBV 5R400 R=400 mm

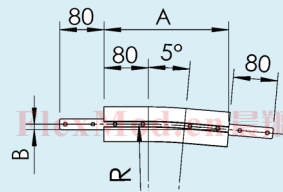

	R	A	B
CXSBV 5R300	300	186	8
CXSBV 5R400	400	195	9

Vertical bend, 7° (垂直弯头7°)

Radius to centre of beam:

(输送梁中心半径)

CXSBV 7R300 R=300 mm

CXSBV 7R400 R=400 mm

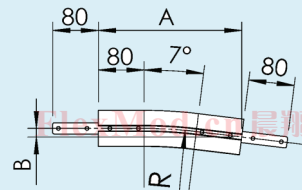

	R	A	B
CXSBV 7R300	300	196	12
CXSBV 7R400	400	208	13

Vertical bend, 15° (垂直弯头15°)

Radius to centre of beam:

(输送梁中心半径)

CXSBV 15R300 R=300 mm

CXSBV 15R400 R=400 mm

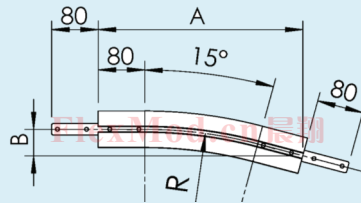

	R	A	B
CXSBV 15R300	300	235	31
CXSBV 15R400	400	261	34

Vertical bend, 30° (垂直弯头30°)

Radius to centre of beam:

(输送梁中心半径)

CXSBV 30R300 R=300 mm

CXSBV 30R400 R=400 mm

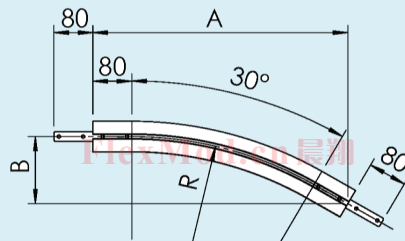

	R	A	B
CXSBV 30R300	300	299	80
CXSBV 30R400	400	349	94

* Note: Special angles on request.

CXS-16

Vertical bends (垂直弯头)

FlexMod®

Vertical bend, 45° (垂直弯头45°)

Radius to centre of beam:

(输送梁中心半径)

CXSBV 45R300 R=300 mm

CXSBV 45R400 R=400 mm

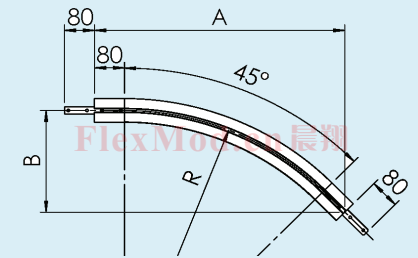

	R	A	B
CXSBV 45R300	300	349	145
CXSBV 45R400	400	419	174

Vertical bend, 60° (垂直弯头60°)

Radius to centre of beam:

(输送梁中心半径)

CXSBV 60R300 R=300 mm

CXSBV 60R400 R=400 mm

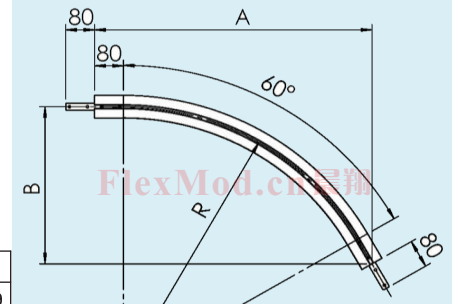

	R	A	B
CXSBV 60R300	300	380	219
CXSBV 60R400	400	466	269

Vertical bend, 90° (垂直弯头90°)

Radius to centre of beam:

(输送梁中心半径)

CXSBV 90R300 R=300 mm

CXSBV 90R400 R=400 mm

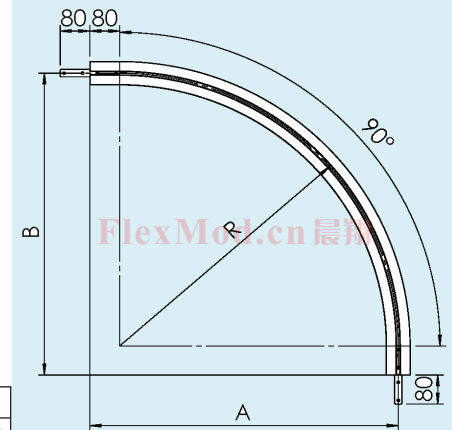

	R	A	B
CXSBV 90R300	300	380	380
CXSBV 90R400	400	480	480

www.flexmod.cn

CXS-17

CXS