



烟草行业输送案例



楔形输送案例

Contents (目录)	2	Idler end units (从动单元)	16
Chains (链条)	5	Horizontal wheel bends (水平轮弯头)	17
Conveyor beam (输送梁)	5	Horizontal plain bends (水平弯头)	20
Articulated beam section (铰接梁)	8	Vertical bends (垂直弯头)	22
End drive units (驱动单元)	9	Angle plates (角撑板)	25
Intermediate drive units (中间驱动单元)	13	Front piece (前挡板)	27
Catenary drive units (悬链驱动单元)	14	Examples of application (应用场合)	29
Horizontal bend drive unit (水平驱动单元)	15		



CXH

Chain width 103 mm (链宽103mm)



Technical characteristics (技术指标)

Chain tension limit (链条张力极限)1250 N
Beam width (型材宽度)105 mm
Chain width (链条宽度)103 mm
Chain pitch (链条节距)35.5 mm
Item width (输送物品宽度)25-300 mm
Maximum item weight (输送物品重量)	
Horizontal transport (水平传送)20 kg
Vertical transport (垂直传送)15 kg
Maximum weight on conveyor (线体最大承载)150-300 kg
Maximum conveyor length (线体最大长度)30 m

Examples of application

Large ball bearings, turbo rotors, safety belt brackets, electric motors, shock absorbers, steering arm components, boxes.

应用场合

卡通箱、大型球轴承、电机转子、汽车零部件、低压开关、仪器仪表、纸巾、包装食品等。

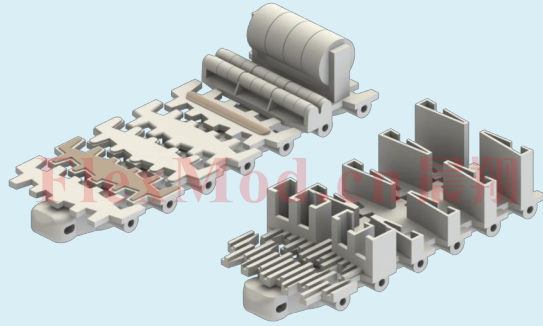

Plastic chain materials(链板材质)	Performance(特性)	Colour(颜色)
POM	Standard material/标准材料	white/白色
POML	Ultra low wear/超润滑	white/白色
POMA	Abrasion resistance/超耐磨	white/白色
POMC	Chemical resistance/抗腐蚀	yellow/黄色
POME	Conductive material/抗静电	black/黑色
POMK	High temperature resistance/耐高温	yellow/黄色
POMF	Food application/用于食品	white/白色
POMN	Low noise/低噪音	white/白色

Plain chain (平板链)

CXHTP 5 Plain chain (平板链)
Length 5 mt (长度5m)

CXHTL 103 Plain link
(平板链节)

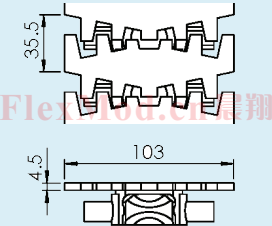
*Cleated chain*
(楔链)

Type A
Length 5 mt (长度5m)

CXHTF 5X15 A... H=15 mm
CXHTF 5X20 A... H=20 mm
CXHTF 5X30 A... H=30 mm
CXHTF 5X40 A... H=40 mm

Cleated link
(楔链节)

CXHTL 103X15 A H=15 mm
CXHTL 103X20 A H=20 mm
CXHTL 103X30 A H=30 mm
CXHTL 103X40 A H=40 mm

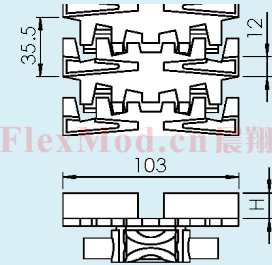
*Friction top chain* (防滑顶链)

CXHTP 5 F... Friction top chain
(防滑顶链)
Length 5 mt (长度5m)

CXHTL 103 F Friction top link
(防滑顶链节)

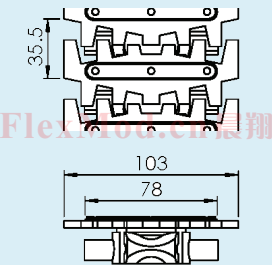
*Steel top chain*
(钢顶链)

CXHTP 5 TF Plain chain(平板链)
Length 5 mt
(长度5m)

CXHTL 103 TF Steel top link
(钢顶链节)

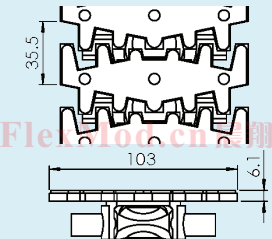

Roller top chain
(滚轮顶链)

CXHTR 5 Roller top chain (滚轮顶链)
Length 5 mt
(长度5m)

CXHTL 103 R Roller top link
(滚轮顶链节)

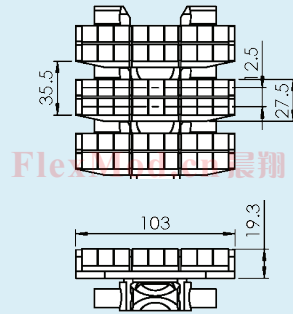

CXHTF 5X46 R... Chain with roller cleats, Length 5 mt
(滚轮楔链, 长度5m)

CXHTL 103X46 R Link with roller cleats
(滚轮楔链节)

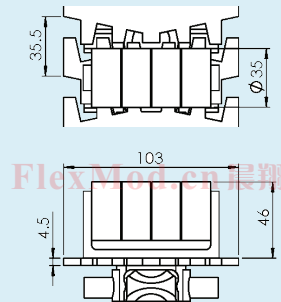

Note. This type of chain requires minimum. One plain link between every cleated link.

Universal chain(通用链)

★晨翔独有

CXHTF 5 U... Length 5 mt (长度5m)

CXHTL 103 U Universal link(通用链)

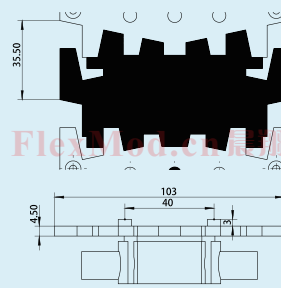

The link has a hole for an M6 screw.
M6 nut will fit inside the link.
(链节中间可装入M6螺母, 用于固定夹具)

Tools and accessories (工具和附件)

CXHTT 18X19 Plastic pivot (塑料珠)

CXHTD 6X70 Steel pin (钢销)

CXBMJ 6P Pin insertion tool
(销子安装工具)

CXHMJ 6 Pin insertion tool
(销子安装工具)

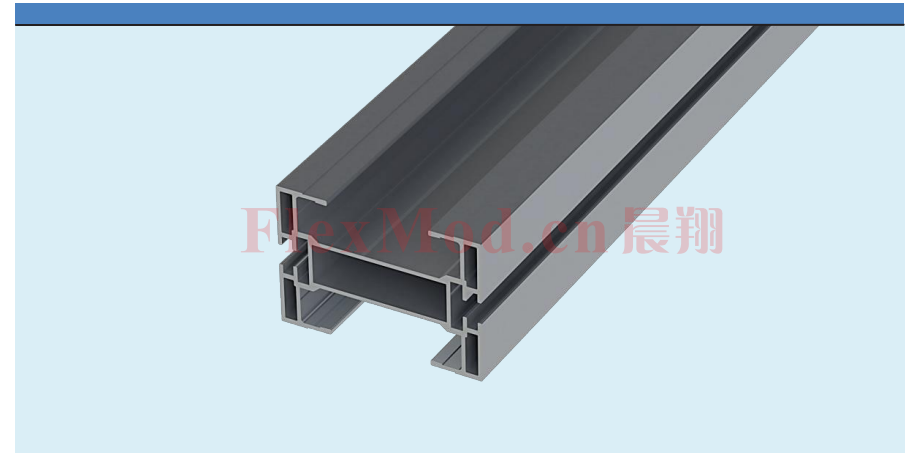

Conveyor beam (输送梁)

FlexMod®

Beam (输送梁)

CXHCB 3 Length 3 m (长度3m)

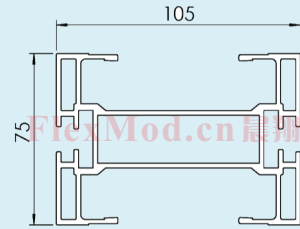

Slide rail (耐磨条)
Length 25 m (长度25m)

CXLCR25 HDPE Black/White (聚乙烯)
CXLCR25U UHMW White (高分子量聚乙烯)
CXLCR 25P PVDF White (聚偏氟乙烯)
CXLCR 25H HDPE+PA6 Gray (尼龙)

CXLCR 25 CXLCR 25H CXLCR 25U/CXLCR 25P



CXLAH 4X6A Aluminium rivet (铝铆钉)
CXLAH 4X8A Aluminium rivet (铝铆钉)

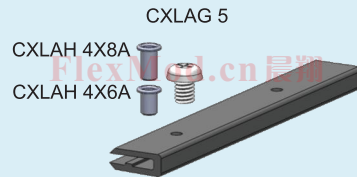

CXLAG 5 Plastic screw (塑料铆钉)

CXHCC 160 Beam section for chain installation, including connection strips and screws (活接梁用于链条拆装)

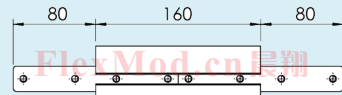

Connecting strip with set screws (梁体连接条)

CXLCJ 6X160 Length 160 mm
CXLCJ 6X130 Length 130 mm

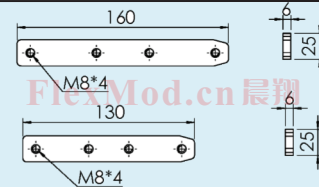

T-slot cover (防尘胶条)

CXLAB 50 Length 50 m (长度50m)

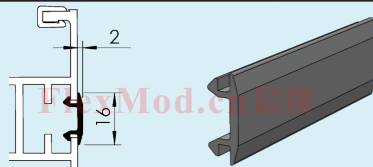

CX3920500 Drill fixture for slide rail (耐磨条安装工具)

CXHMR 200 CX3920500

CXHMR 200 Mounting tool (铆钉安装工具)

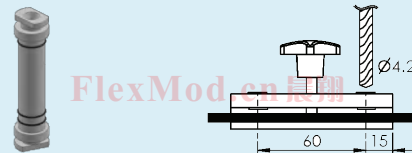

CXH-6

Conveyor beam (输送梁)

FlexMod®

Half beam (半梁)

CXHCB 3H Length 3 m (长度3m)

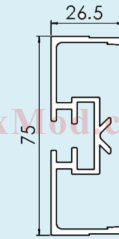

Mounting Clip (半梁夹)

CXHCE 69X30

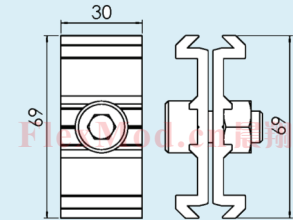

Split Conveyor beam assembled (组合式输送梁)

Length 3m (长度3m)

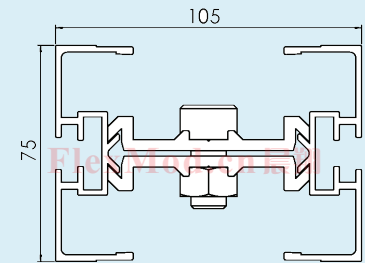

Beam spacer (型材隔条)

CXLCD 3 Aluminium, anodized (阳极处理)
Length 3m (长度3m)

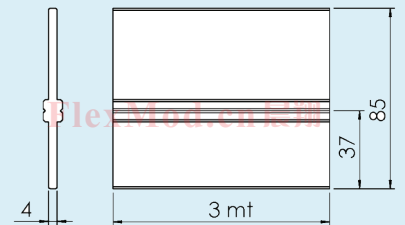

CXS	H=16.0mm
CXL	H=15.9mm
CXM/CX85/CXH	H=10.5mm
CXK	H=0.5mm

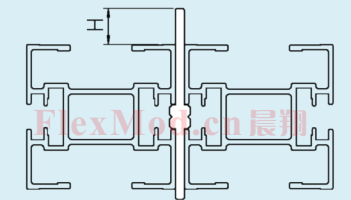

www.flexmod.cn

CXH-7

CXH

Articulated beam section (铰接梁)

FlexMod®

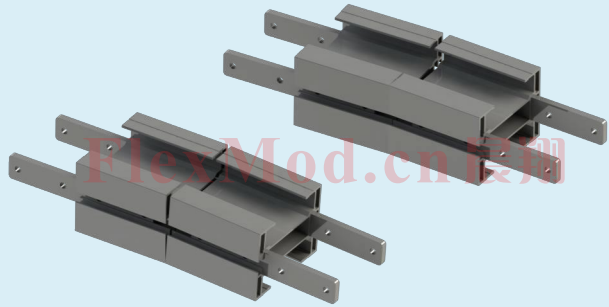

CXHCH 5V Articulated beam section, vertical

CXHCH 5H Articulated beam section, horizontal

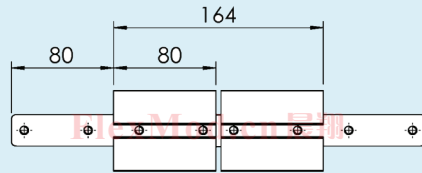

Slide rail: see "Conveyor beam".

CXH-8

End drive units (驱动单元)

FlexMod®



CXHEB 0HLGUA Drive unit (驱动单元)
 Dia. 25mm to 20mm Direct drive (直接驱动)
 left-hand side (左出轴)
 SEW SA37
 SEW WA30
 SEW WA 20

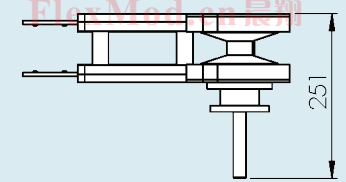
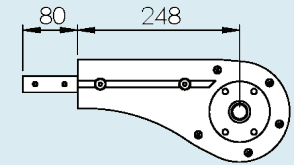

CXHEB 0HRGUA Drive unit (驱动单元)
 Dia. 25mm to 20mm Direct drive (直接驱动)
 right-hand side (右出轴)
 SEW SA37
 SEW WA30
 SEW WA 20

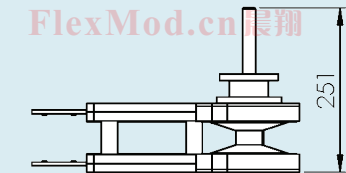
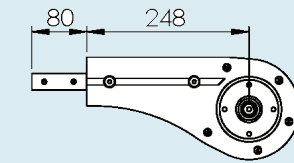

CXH

www.flexmod.cn

CXH-9

End drive units (驱动单元)

FlexMod®

CXHEB 0HLGP Drive unit (驱动单元)
Direct drive without
slack, left-hand side
(左出轴)

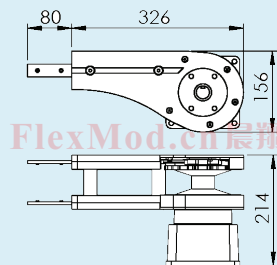

CXHEB 0HRGP Drive unit (驱动单元)
Direct drive without
slack, right-hand side
(右出轴)

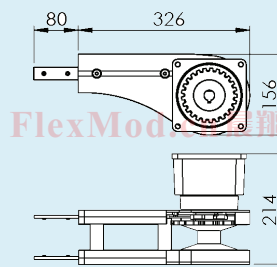

CXHEB 0HLP Drive unit (驱动单元)
Direct drive (直接驱动)
left-hand side (左出轴)

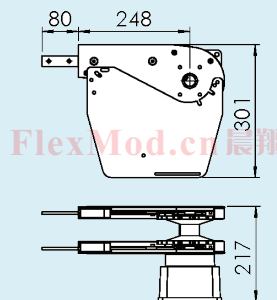

CXHEB 0HRP Drive unit (驱动单元)
Direct drive (直接单元)
right-hand side (右出轴)

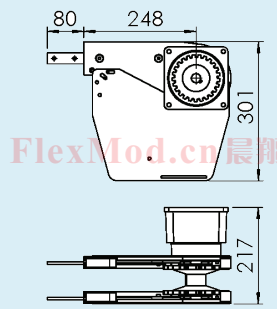

CXH-10

End drive units (驱动单元)

FlexMod®

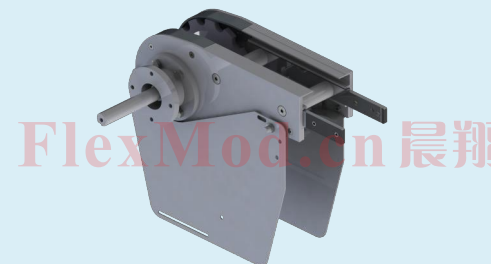

CXHEB 0HLUA Drive unit (驱动单元)
Dia. 25mm to 20mm Direct drive (直接单元)
left-hand side (左出轴)
SEW SA37
SEW WA 30
SEW WA 20

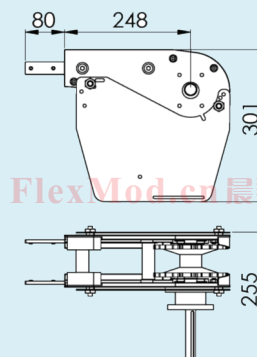

CXHEB 0HRUA Drive unit (驱动单元)
Dia. 25mm to 20mm Direct drive (直接单元)
right-hand side (右出轴)
SEW SA37
SEW WA 30
SEW WA 20

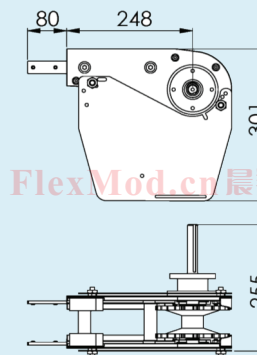

www.flexmod.cn

CXH-11

CXH

End drive units (驱动单元)

FlexMod®

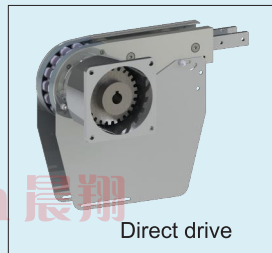

CXHEB 0HLA Drive unit (驱动单元)
Transmission on left-hand side
(传动装置在左侧)

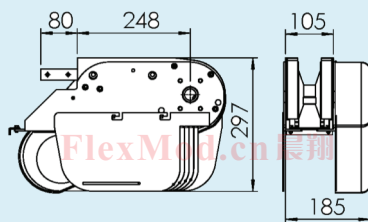

CXHEB 0HRA Drive unit (驱动单元)
Transmission on right-hand side
(传动装置在右侧)

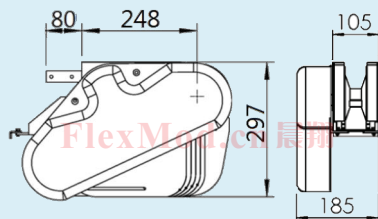

CXH-12

Intermediate drive units (中间驱动单元)

FlexMod®

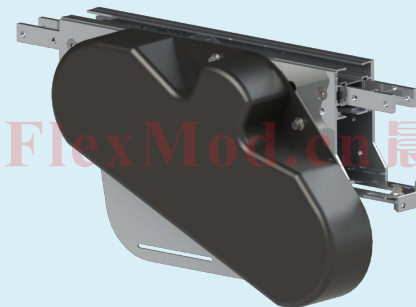

CXHER 0HL Drive unit (驱动单元)
Transmission on left-hand side
(传动装置在左侧)

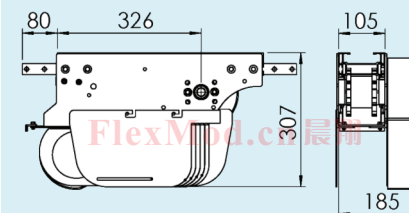

CXHER 0HR Drive unit (驱动单元)
Transmission on right-hand side
(传动装置在右侧)

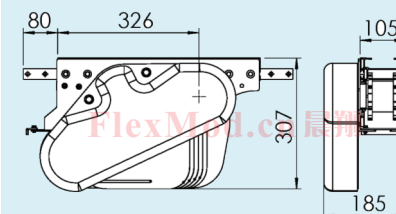

www.flexmod.cn

CXH-13

CXH

Catenary drive units (悬链驱动单元)

FlexMod®

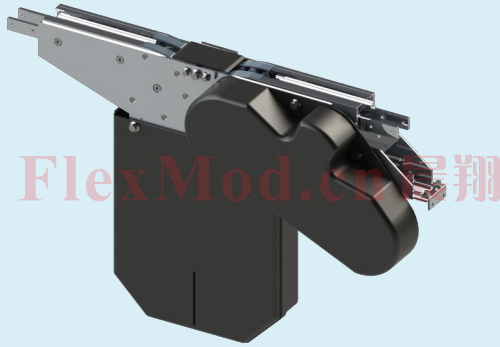

CXHEC 0HL Drive unit (驱动单元)
Transmission on left-hand side
(传动装置在左侧)

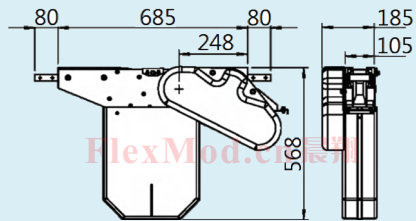

CXHEC 0HR Drive unit (驱动单元)
Transmission on right-hand side
(传动装置在右侧)

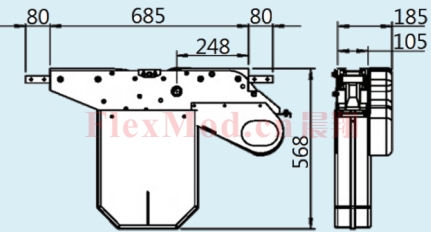

CXH-14

Horizontal bend drive unit (水平驱动单元)

FlexMod®



CXHEW 180/0H Horizontal bend drive unit, 180°
(水平驱动单元180°)

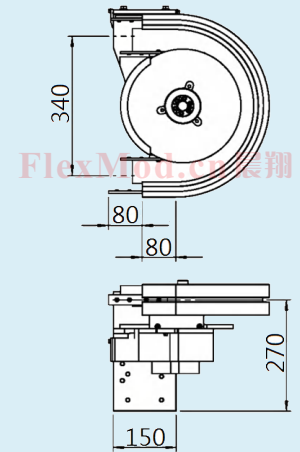

CXH

www.flexmod.cn

CXH-15

Idler end units (从动单元)

FlexMod®



CXHEJ 315 Idler end unit
(从动单元)

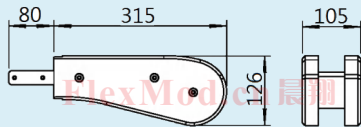

CXHEJ 325 Idler end unit
(从动单元)

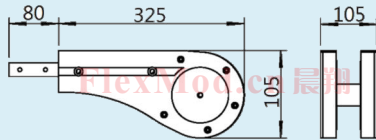

CXHSJ 195 Protective cover for
idler end nit

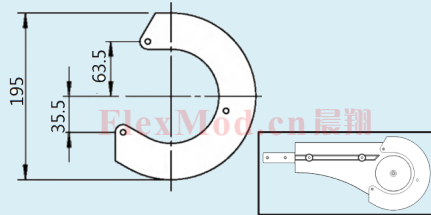

CXHEK 90R50 Idler bend unit, 90°
Cannot be used with
a return chain
(90°从动单元)

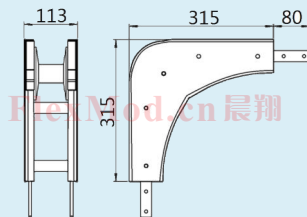

Horizontal wheel bends (水平轮弯头)

FlexMod®



Horizontal wheel bends (水平轮弯头)

FlexMod®

Horizontal wheel bend, 30° (水平轮弯头30°)

- CXHBH 30R170 Radius to centre of chain 170 mm (链条中心半径170mm)
 CXHBH 30R170A with protective cover

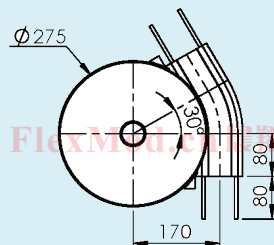

Horizontal wheel bend, 45° (水平轮弯头45°)

- CXHBH 45R170 Radius to centre of chain 170 mm (链条中心半径170mm)
 CXHBH 45R170A with protective cover

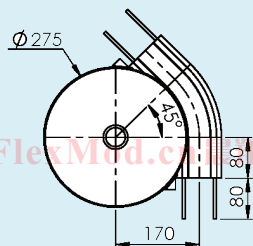

Horizontal wheel bend, 60° (水平轮弯头60°)

- CXHBH 60R170 Radius to centre of chain 170 mm (链条中心半径170mm)
 CXHBH 60R170A with protective cover

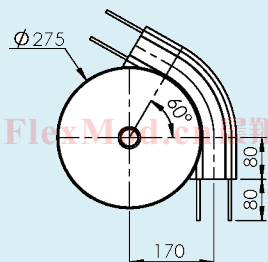

Horizontal wheel bend, 90° (水平轮弯头90°)

- CXHBH 90R170 Radius to centre of chain 170 mm (链条中心半径170mm)
 CXHBH 90R170A with protective cover

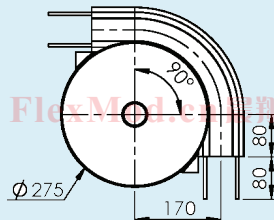

CXH-18

Horizontal wheel bends (水平轮弯头)

FlexMod®

Horizontal wheel bend, 120° (水平轮弯头120°)

- CXHBH 120R170 Radius to centre of chain 170 mm (链条中心半径170mm)
 CXHBH 120R170A with protective cover

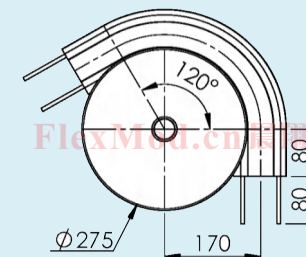

Horizontal wheel bend, 180° (水平轮弯头180°)

- CXHBH 180R170 Radius to centre of chain 170 mm (链条中心半径170mm)
 CXHBH 180R170A with protective cover

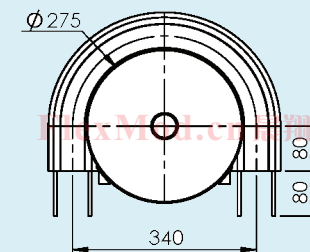

Horizontal wheel bend, 210° (水平轮弯头210°)

- CXHBH 210R170 Radius to centre of chain 170 mm (链条中心半径170mm)
 CXHBH 210R170A with protective cover

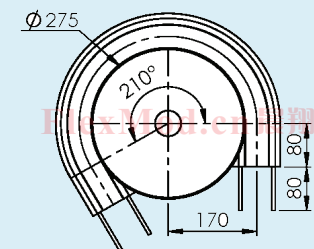

www.flexmod.cn

CXH-19

CXH

Horizontal plain bends (水平弯头)

FlexMod®



Horizontal plain bends (水平弯头)

FlexMod®

Horizontal plain bend, 30° (水平弯头30°)
Radius to centre of beam:
(输送梁中心半径)

CXHBP 30R500 R=500 mm
CXHBP 30R700 R=700 mm
CXHBP 30R1000 R=1000mm

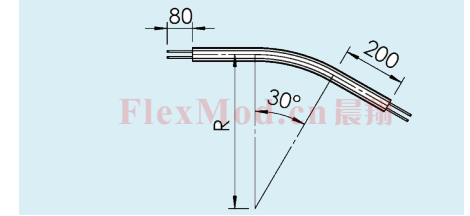

Horizontal plain bend, 45° (水平弯头45°)
Radius to centre of beam:
(输送梁中心半径)

CXHBP 45R500 R=500 mm
CXHBP 45R700 R=700 mm
CXHBP 45R1000 R=1000mm

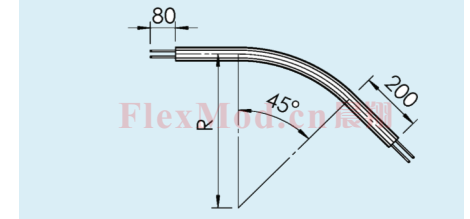

Horizontal plain bend, 60° (水平弯头60°)
Radius to centre of beam:
(输送梁中心半径)

CXHBP 60R500 R=500 mm
CXHBP 60R700 R=700 mm
CXHBP 60R1000 R=1000mm

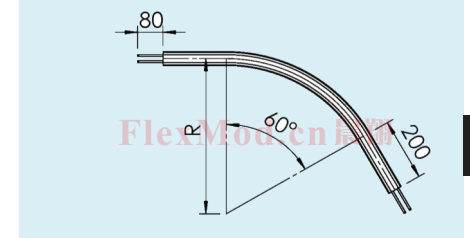

Horizontal plain bend, 90° (水平弯头90°)
Radius to centre of beam:
(输送梁中心半径)

CXHBP 90R500 R=500 mm
CXHBP 90R700 R=700 mm
CXHBP 90R1000 R=1000mm

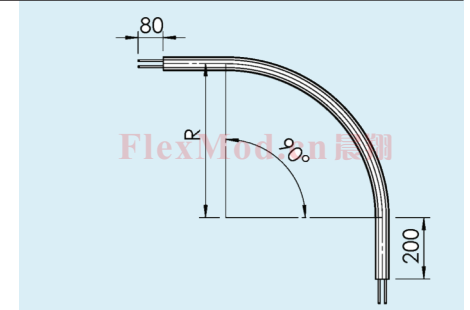

Support rail for plain bends

CX5048598 Length 2.4mt

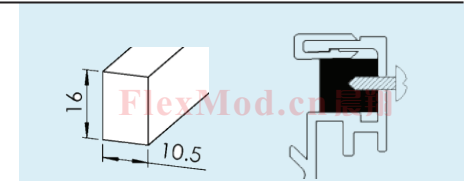

Vertical bends (垂直弯头)

FlexMod®

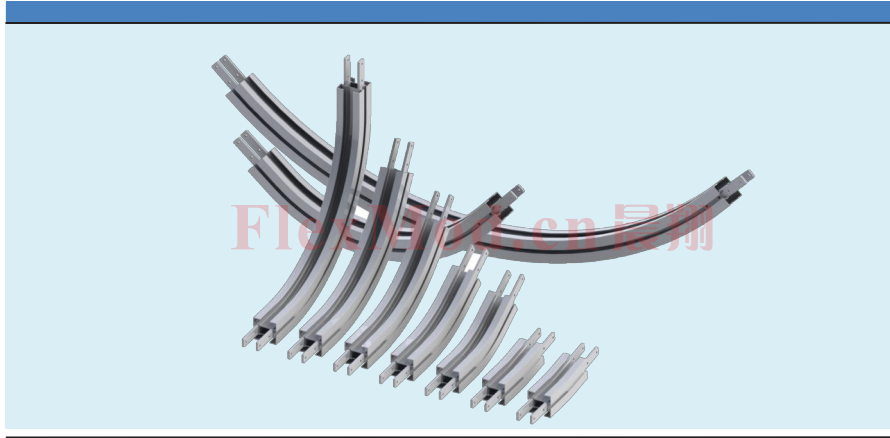

Vertical bends (垂直弯头)

FlexMod®

Vertical bend, 5° (垂直弯头5°)

Radius to centre of beam:
(输送梁中心半径)

CXHBV 5R400 R=400 mm

	R	A	B
CXHBV 5R400	400	195	9

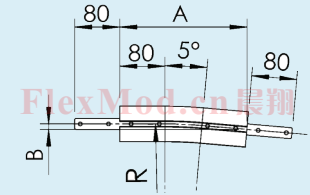

Vertical bend, 7° (垂直弯头7°)

Radius to centre of beam:
(输送梁中心半径)

CXHBV 7R400 R=400 mm

	R	A	B
CXHBV 7R400	400	208	13

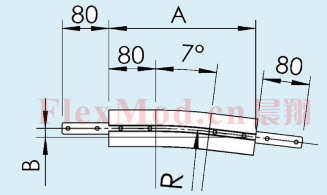

Vertical bend, 15° (垂直弯头15°)

Radius to centre of beam:
(输送梁中心半径)

CXHBV 15R400 R=400 mm

CXHBV 15R700 R=700 mm

	R	A	B
CXHBV 15R400	400	261	34
CXHBV 15R700	700	338	45

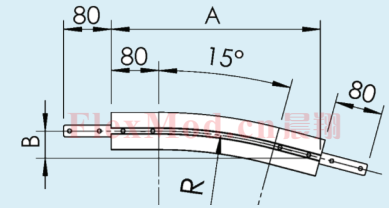

Vertical bend, 30° (垂直弯头30°)

Radius to centre of beam:
(输送梁中心半径)

CXHBV 30R400 R=400 mm

CXHBV 30R1000 R=1000 mm

	R	A	B
CXHBV 30R400	400	349	94
CXHBV 30R1000	1000	649	174

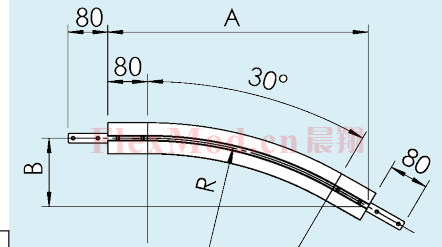

Vertical bends (垂直弯头)

FlexMod®

Vertical bend, 45° (垂直弯头45°)

Radius to centre of beam:

(输送梁中心半径)

CXHBV 45R400 R=400 mm
 CXHBV 45R1000 R=1000 mm

	R	A	B
CXHBV 45R400	400	419	174
CXHBV 45R1000	1000	844	350

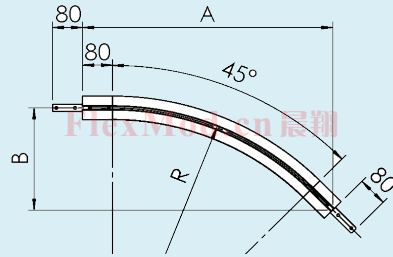

Vertical bend, 60° (垂直弯头60°)

Radius to centre of beam:

(输送梁中心半径)

CXHBV 60R400 R=400 mm
 CXHBV 60R1000 R=1000 mm

	R	A	B
CXHBV 60R400	400	466	269
CXHBV 60R1000	1000	986	569

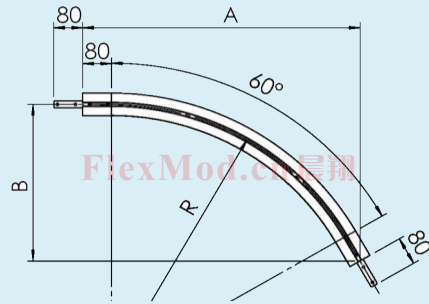

Vertical bend, 90° (垂直弯头90°)

Radius to centre of beam:

(输送梁中心半径)

CXHBV 90R400 R=400 mm
 CXHBV 90R1000 R=1000 mm

	R	A	B
CXHBV 90R400	400	480	480
CXHBV 90R1000	1000	1080	1080

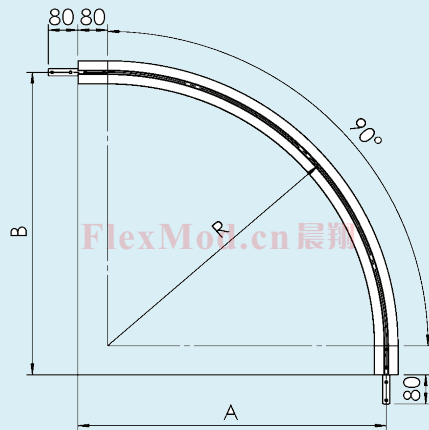

Angle plates (角撑板)

FlexMod®

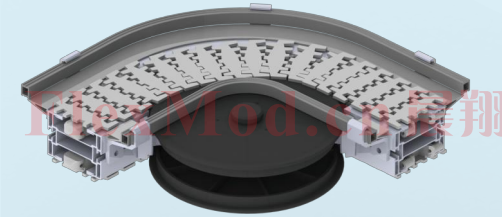

Angle plates (角撑板)

FlexMod®

Angle plate(角撑板)

CXHRP 3 Length 3 mt
(长度3m)

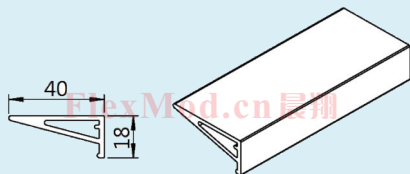

Angle plate(角撑板)

CXHRM 90 Angle plate for 90° bend
Used with CXHBH 90R170
Inner radius 222.5 mm

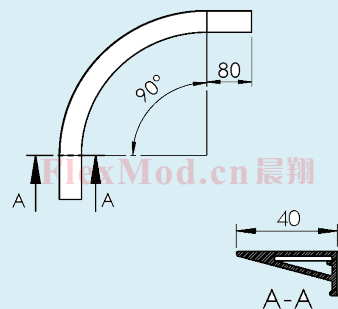

Angle plate(角撑板)

CXHRM 180 Angle plate for 180° bend
Used with CXHBH 180R170
and CXHEW 180/ H
Inner radius 222.5 mm

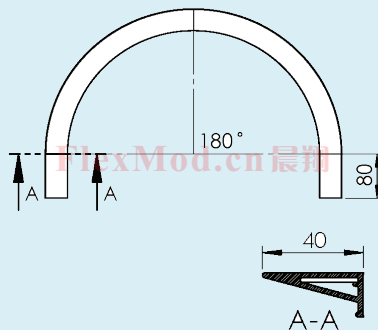

CXH-26

Front piece (前挡板)

FlexMod®



www.flexmod.cn

CXH-27

Front piece (前挡板)

FlexMod®

CXHVF 3	Front piece(前挡板) Length 3 mt(长度3m)	
CXHVG 2	Sliding strip for front piece, Length 2 mt	
CXHVA 45R460	Upper bend, 45° Radius 460 mm Includes connecting strip with screws	
CXHVA 60R460	Upper bend, 60° Radius 460 mm Includes connecting strip with screws	
CXHVB 45R335	Lower bend, 45° Radius 335 mm Includes connecting strip with screws	
CXHVB 60R335	Lower bend, 60° Radius 335 mm Includes connecting strip with screws	
CXHVK 43	Linkage kit for front piece W=170 mm D= 43 mm	
Kit consists of two support pairs.		
CXHVS 43	Bend support D=43mm	
CXHVS 93	Bend support D=93mm	

CXH-28

Examples of application (应用场合)

FlexMod®



后包装输送案例



高空输送案例

www.flexmod.cn

CXH-29

CXH